

BOZZYS®

WENZHOU BOSHI SAFETY PRODUCTS CO.,LTD

Address: Building 13, Wenzhou Safety (Emergency) Industrial Park,
Oujiangkou New Area, Dongtou District, Wenzhou, Zhejiang Province, China
Phone: +86-577-57155522
Mobile: +86-13587463882
Postal Code: 325606



PRODUCT
CATALOGUE I



The Leader in Mobile Electrical Safety Solutions
PIONEERS IN THE BATTERY INDUSTRY









CATALOGUS

Product Selection Catalog

Company Introduction

-  Company Profile..... 03
-  Development History..... 04

Product Introduction

-  Miner's Lamp..... 05
-  Principle Overview..... 19
-  Metal-Air Battery 23
-  Portable General Lamps..... 41
-  Emergency Lighting Lamps..... 137
-  Portable Courtyard Lamps..... 159
-  Portable Civilian Lamps..... 163



COMPANY PROFILE



Wenzhou Boshi Electric Technology Co., Ltd., founded in Jan. 2006, specializes in R&D and production of emergency lighting, industrial lighting, and new energy products after 20 years of development, offering stable emergency lighting solutions.

It has developed mining lamps (KL2.8LM, KL4.5LM series), explosion-proof flashlights (SP-1 to SP-4), KL2.5LM explosion-proof headlamps, and civil lamps.

Also focusing on new energy environmental protection, it owns pollution-free metal-air batteries (6V, No.1, No.5, etc.) and non-standard power & lighting solutions, with multiple patents and certifications like ATEX, MA, CE, ROHS.

Guided by "Quality for benefits, innovation for development" and the principle of "Learning, communicating, sharing, progressing", it integrates economic benefits with employee growth and social responsibility, aiming to create the future with you.



PROFESSIONAL AND RELIABLE ENERGY SOLUTIONS

Professional Tech Team

With independent R&D and multiple patent certifications, we meet

Modern Production

Equipped with automated lines and precision equipment, each process is refined for near-perfect products.

Professional After-sales Team

We serve customers 24/7. Solving problems efficiently is our commitment.

Corporate development history

Jan.2006-2010: Based in a 300m² office in Hongyu Village,Beibaixiang,Yueqing, mainly produced new LED lithium battery mining lamps like KL2.8LM and KL4.5LM series.

Mar.2010-Oct.2015:Moved to a 2,000m² factory in Malujiao Industrial Park, Beibaixiang,Yueqing.Expanded LED lithium battery mining lamp lines (added NEWKL3, KL5LM,etc.) and launched LOTO locks in 2010.

Dec.2015-Dec.2023:Settled in an 8,000m² factory in Jinpan,Yueqing.Developed metal-air batteries and products like keys-O1 salt-water lamps.

2024-Present: Located in Zone 15,Wenzhou Safety Emergency Industrial Park, Wenzhou Marine Economic Development Zone(self-owned 11,000m² factory). Focused on R&D and production of core materials for metal-air batteries, and developed eco-friendly, long-standby self-generating battery power and lighting products (e.g.,Z50 series lamps,D/V6 batteries,power banks,large aluminum-air power generators).

INDUSTRIAL MINING LAMPS AND EMERGENCY

Enterprise Value

Focus, Continuity, Refinement, Achievement

Vision

With innovation as the engine and quality as the foundation, we protect the safety of users' lives.

Mission

People-Oriented, Focused on Security



Mining lamps

► Introduction

LED lamp beads, high/low two-level light source, high brightness mode battery life >13 hours, low brightness mode battery life >36 hours.

BK2000-MINING CAP LAMP

Product Name: Mining Safety Helmet Light	Battery Capacity: 2200mAh
Main/Auxiliary Light Illuminance: 6500/20LUX	Main/Auxiliary Light Operating Current: 160 / 60 mA
Main/Auxiliary Light Operating Time: 13/36hours	Main Light LED Power: 1W
Weight: 171g	Battery Type: Lithium-ion Battery (18650 type)
Battery Rated Voltage: 3.7V	Casing Material: ABS Engineering Material
Light Cup Material: Aluminum Alloy	Waterproof Rating: IP65

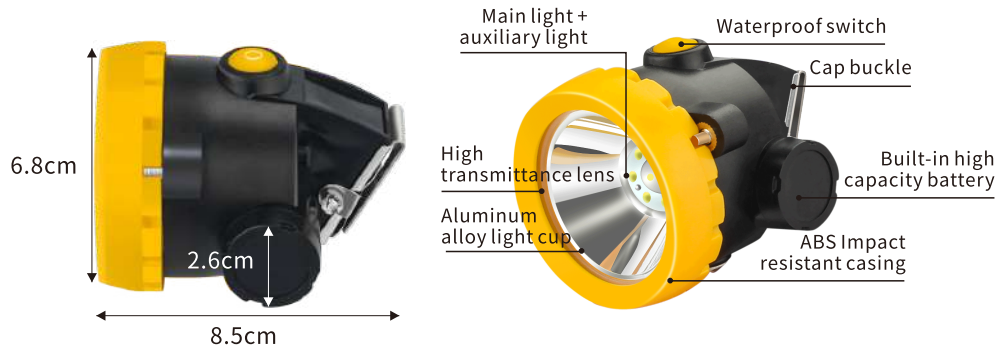

► Introduction

LED lamp beads, high/low light dual-level light source, high light endurance >12h, low light endurance >25h.

BK3000-MINING CAP LAMP

Product Name: Mining cap lamp	Battery capacity: 2200mAh
Illumination main light/auxiliary light: 4200/320 (LUX)	Working current main light/auxiliary light: 170/85 (mAh)
Working time main light/auxiliary light: 12/25 (h)	Main light LED power: 1(W)
Weight: 195 (g)	Battery type: Lithium battery (18650)
Battery rated voltage: 3.7 (V)	Material of the shell: ABS
Material of the lightshade: Aluminum	Waterproof IP grade: IP56

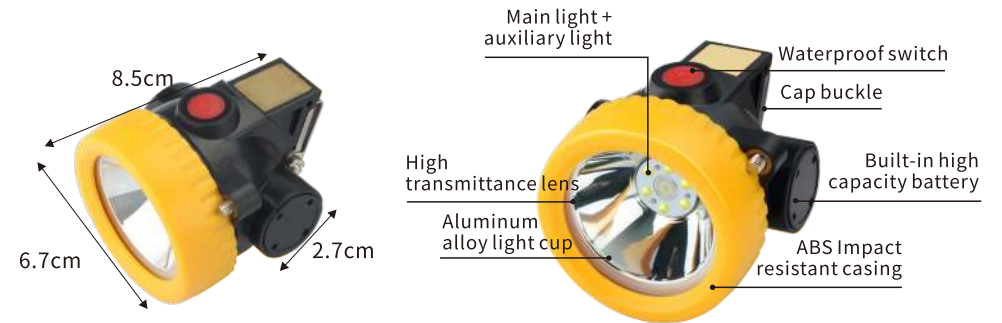

► **Introduction**

LED lamp beads, high/low two-level light source, high brightness mode battery life >16 hours, low brightness mode battery life >31 hours.

KJ3.5LM-Coal Mine Mining Lamp

Product Name: Coal mine special miner lamp

Main/Auxiliary Light Illuminance: 3600/600 LUX

Battery Rated Voltage: 3.6 V

Charging Method: 6V/800 mA

Main Light Endurance: >16 hours

Light Cup Material: Aluminum Alloy

Casing Material: ABS Engineering Material

Battery Capacity: 3500 mAh

Battery Type: NiMH (Model 18650)

Weight: 458 g

Main LED Power: 1 W

Auxiliary Light Life: >31 hours

Waterproof Rating: Ip56



Removable safety helmets

Note: Safety helmets are not included in the auxiliary product category.

► **Introduction**

LED lamp beads, high/low two-level light source, high brightness mode battery life >16 hours, low brightness mode battery life >18 hours.

KL2LM-Head-mounted mining lamp for coal mines

Product Name: Coal mine special miner lamp

Main/Auxiliary Light Illuminance: 5300/1940 LUX

Battery Rated Voltage: 3.6 V

Charging Method: 4.3V / 600mA

Main Light Endurance: >16 hours

Light Cup Material: Aluminum Alloy

Casing Material: ABS Engineering Material

Battery Capacity: 2000 mAh

Battery Type: NiMH (14490 type)

Weight: 458 g

Main LED Power: 1 W

Auxiliary Light Life: >31 hours

Waterproof Rating: Ip56



Removable safety helmets

Note: Safety helmets are not included in the auxiliary product category.

► **Introduction**

LED lamp beads, high/low two-level light source, high brightness mode battery life >23 hours, low brightness mode battery life >38 hours.

KL5LM-SPECIAL MINER'S LAMP FOR COAL MINE ➡

Product Name: Coal Mine Mining Lamp

Main/Auxiliary Lamp Illumination: 5200 /1200 LUX

Battery Rated Voltage: 3.7v

Working current: 210/130mA

Main Light Endurance: >23hours

Light Cup Material: Aluminum Alloy

Casing Material: ABS Engineering Material

Battery Capacity:5000 mAh

Battery Type: Lithium-ion Battery (18500 type)

Weight: 473g

Main LED Power: 1 W

Auxiliary Lighting Lifetime: >38 hours

Waterproof Rating: IP 56

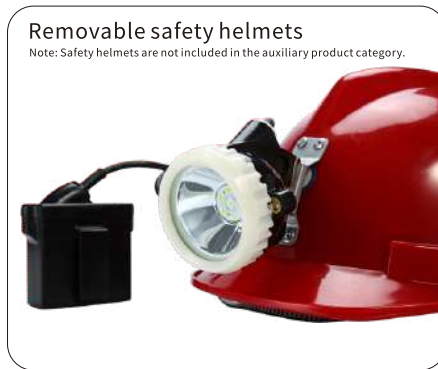

► **Introduction**

LED lamp beads, high/low two-level light source, high brightness mode battery life >16 hours, low brightness mode battery life >55 hours.

KL6LM-Coal Mine Mining Lamp ➡

Product Name: Coal Mine Mining Lamp

Main/Auxiliary Light Illuminance: 12500/1850 LUX

Battery Rated Voltage: 3.7V

Working current: 400/ 120 mA

Main Light Endurance: >16 hours

Light Cup Material: PC

Casing Material: ABS Engineering Material

Battery Capacity:6600 mAh

Battery Type: Lithium-ion Battery (18500 type)

Weight: 500g

Main LED Power: 3 W

Auxiliary Lighting Lifetime: >55 hours

Waterproof Rating: IP 56

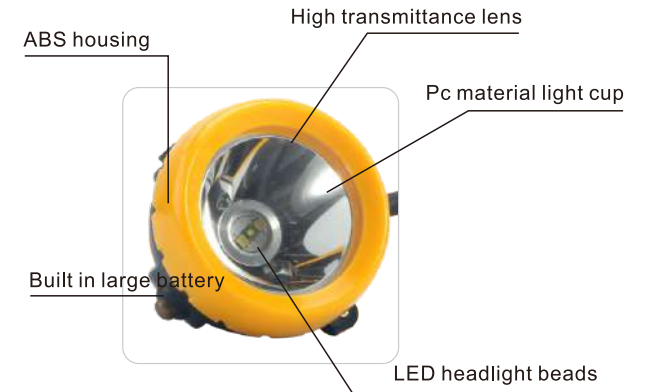

► **Introduction**

LED lamp beads, high/low two-level light source, high brightness mode battery life >18 hours, low brightness mode battery life >25 hours.

KL2.8LM(A)-Head-mounted industrial mining lamp

Product Name: Head-mounted industrial mining lamp	Battery Capacity: 2800 mAh
Main/Auxiliary Light Illuminance: 5500/1320 LUX	Battery Type: Lithium-ion Battery (18500 type)
Battery Rated Voltage: 3.7V	Weight: 134.5 g
Working current: 150/110 mA	Main LED Power: 1W
Main Light Endurance: >18 hours	Auxiliary Lighting Lifetime: >25 hours
Light Cup Material: Aluminum Alloy	Waterproof Rating: IP 56
Casing Material: PC Engineering Material	

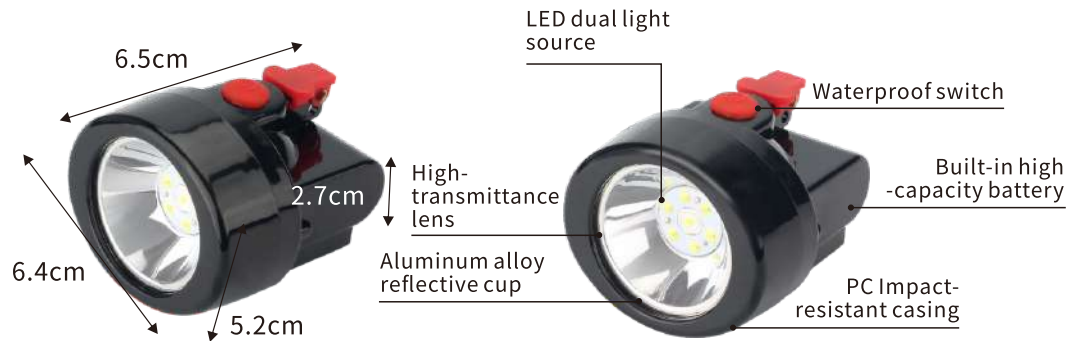

► **Introduction**

LED lamp beads, high/low two-level light source, high brightness mode battery life >9 hours, low brightness mode battery life >28 hours.

KL2.8LM(B)-Head-mounted industrial mining lamp

Product Name: Head-mounted industrial lighting for mining	Battery Capacity: 2800 mAh
Main/Auxiliary Light Illuminance: 10300/2590 LUX	Battery Type: Lithium-ion Battery (18500 type)
Battery Rated Voltage: 3.7V	Weight: 141 g
Working current: 300/100 mA	Main LED Power: 3W
Main Light Endurance: >9 hours	Auxiliary Lighting Lifetime: >18 hours
Light Cup Material: Aluminum Alloy	Waterproof Rating: IP 56
Casing Material: PC Engineering Material	

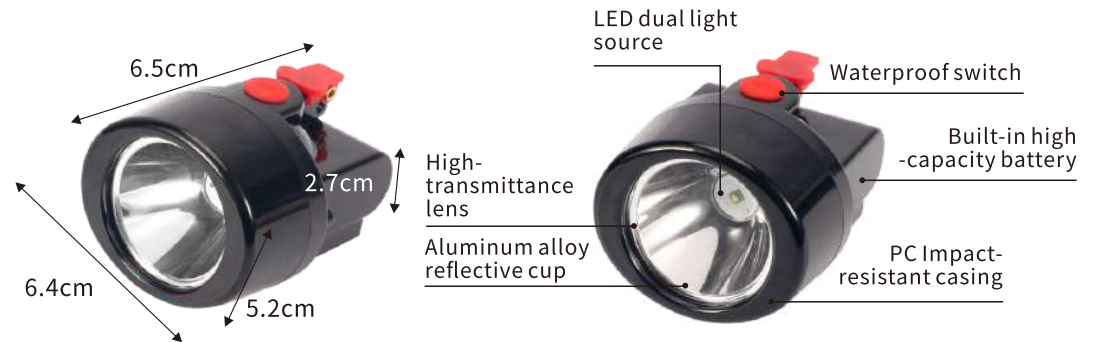

► **Introduction**

LED lamp beads, high beam/low beam dual-mode light source, high beam endurance time >14h, low beam endurance time >47h.

KL4.5LM-Head-mounted industrial mining lamp ◀▶

Product Name: Head-mounted industrial lighting for mining	Battery Capacity: 4500 mAh
Main/Auxiliary Light Illuminance: 7500/200 LUX	Battery Type: Lithium-ion Battery (18500 type)
Battery Rated Voltage: 3.7V	Weight: 230 g
Working current: 320/95 mA	Main LED Power: 3 W
Main Light Endurance: >14 hours	Auxiliary Lighting Lifetime: >47 hours
Light Cup Material: PC	Waterproof Rating: IP 56
Casing Material: ABS Engineering Material	

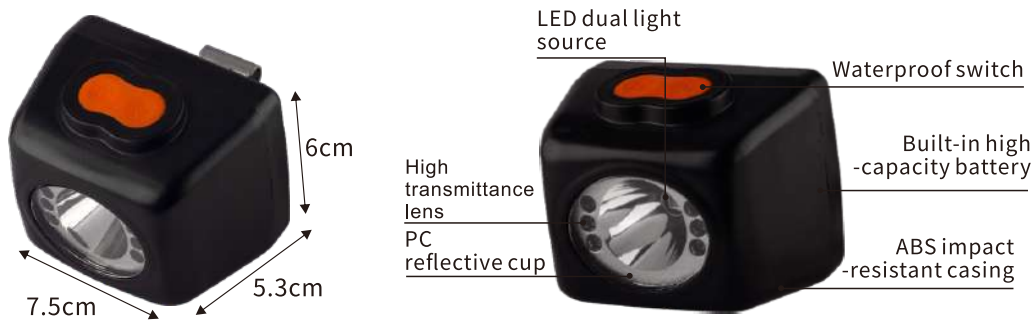

► **Introduction**

LED lamp beads, high/low two-level light source, high brightness mode battery life >16 hours, low brightness mode battery life >50 hours. Obtained ATEX certification.

New KL2.5-Head-mounted industrial mining lamp ◀▶

Product Name: Head-mounted industrial lighting for mining	Battery Capacity: 2500 mAh
Main/Auxiliary Light Illuminance: 6000/20 LUX	Battery Type: Lithium-ion Battery (18500 type)
Battery Rated Voltage: 3.7V	Weight: 159 g
Working current: 150/50 mA	Main LED Power: 1 W
Main Light Endurance: >16 hours	Auxiliary Lighting Lifetime: >50 hours
Light Cup Material: Aluminum Alloy	Waterproof Rating: IP 56
Casing Material: PC Engineering Material	

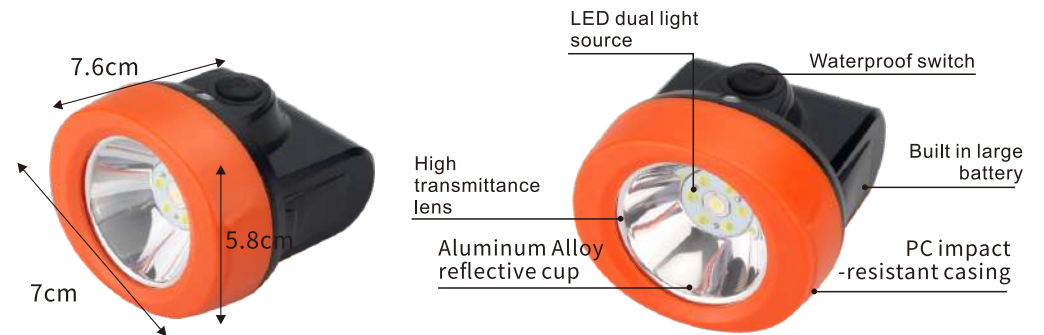

► **Introduction**

LED lamp beads, high/low two-level light source, high brightness mode battery life >16 hours, low brightness mode battery life >50 hours. Obtained ATEX certification.

NEW-KL6LM-Head-mounted industrial mining lamp

Product Name: Head-mounted industrial lighting for mining	Battery Capacity: 6000mAh
Main/Auxiliary Light Illuminance: 8500/150 LUX	Battery Type: Lithium-ion Battery (18500 type)
Battery Rated Voltage: 3.7V	Weight: 195 g
Working current: 220/100 mA	Main LED Power: 3 W
Main Light Endurance: >23 hours	Auxiliary Lighting Lifetime: >50 hours
Light Cup Material: PC	Waterproof Rating: IP 56
Casing Material: PC Engineering Material	

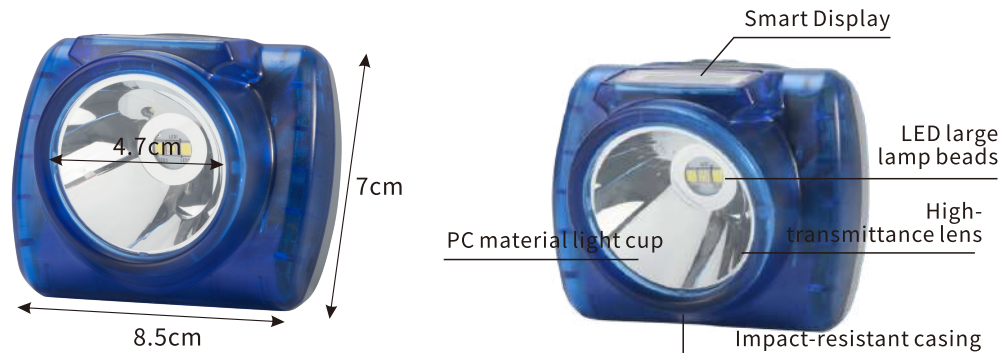

► **Introduction**

LED lamp beads, high beam/low beam dual-mode light source, high beam endurance time >14h, low beam endurance time >35h.

New KL3 HEADWORN INDUSTRIAL MINER'S LAMP

Product Name: Head-mounted industrial lighting for mining	Battery Capacity: 2800 mAh
Main/Auxiliary Light Illuminance: 6600/100 LUX	Battery type: Lithium-ion battery (polymer soft pack)
Battery Rated Voltage: 3.7V	Weight: 148 g
Working current: 190/80 mA	Main LED Power: 3 W
Main Light Endurance: >14 hours	Auxiliary Lighting Lifetime: >35 hours
Light Cup Material: Aluminum	Waterproof Rating: IP 56
Casing Material: ABS Engineering Material	

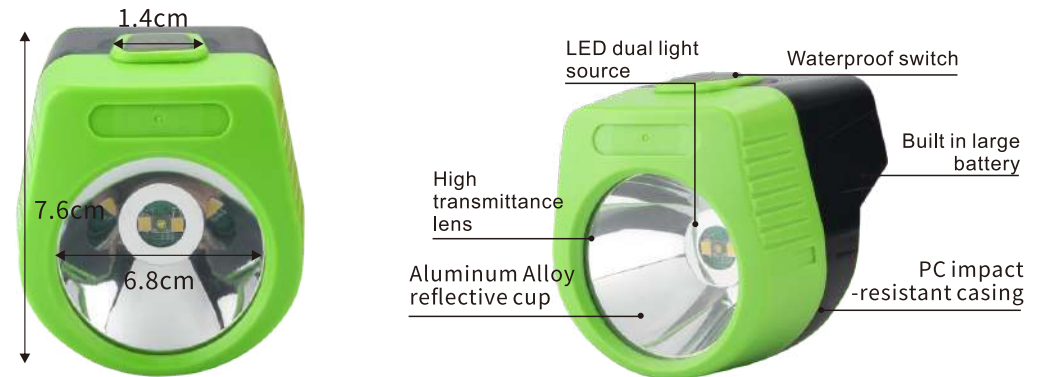

► **Introduction**

This product features a maintenance-free LED light source with high light efficiency and a long lifespan. It's powered by a lithium battery and is suitable for coal mines, tunnel construction, nighttime communications, railway construction, public security, firefighting, and petrochemical enterprises such as steel, oil fields, and more.

BK1000-Mining lamp with integrated cap ➤

Product Name: Mining lamp with integrated cap	Size : 30.5*21.5 15 cm
Main Light Illuminance: 3000 LUX	Weight: 670g
Battery Rated Voltage: 3.7V	Rated Capacity: 2.8Ah
Working current: 220/ 100 mA	Lighting Time (Main Light): >15 hours
Main Light Endurance: >30 hours	Lighting Time (Auxiliary Light): >28 hours
Light Cup Material: Aluminum Alloy	
Casing Material: PC Engineering Material	



Casing Material:
PC Engineering Material



Light Cup Material:
Aluminum Alloy



► **Introduction**

Light Source: Dual high-brightness LEDs (high efficiency, energy-saving) Color: 120.5 × 90.7 × 39.7 / Headlight 068 Net Weight: 578.5g Application: Designed for mining outdoor use

T7-Colliery- specific Mining Lamp ➤

Product Name: Colliery- specific Mining Lamp	Battery Capacity: 600mAh
Main/Auxiliary Light Illuminance: 13120/200LUX	Battery type: Lithium-ion battery (18650 type)
Battery Rated Voltage: 3.7V	Weight: 148 g
Working current: DC4.2V	Main LED Power: 3 W
Main Light Endurance: >14 hours	Auxiliary Lighting Lifetime: >35 hours
Light Cup Material: PC	Waterproof Rating: IP 56
Casing Material: ABS Engineering Material	



► Introduction

This self-rescuer is a personal respiratory protective device for use in coal mines. It is primarily used in underground coal mining operations, but can also be used for other underground operations. When a fire, gas explosion, coal dust explosion, or other disaster occurs, endangering the lives of workers, workers can wear it immediately to protect themselves from carbon monoxide poisoning and safely evacuate the disaster site. The self-rescuer must be carried at all times and ready for immediate use.

The ZL60 carbon monoxide filter self-rescuer complies with the MT709-1997 standard. The carbon monoxide catalyst used in the product meets the requirements of the MT869-2000 standard, and the desiccant used in the product meets the requirements of the MT866-2000 standard.

The product model is ZL60D, where Z stands for self-rescuer and L stands for filter type. ZL indicates a carbon monoxide filter-type self-rescuer, and 60 indicates that the rated protection time of the self-rescuer under moderate labor intensity is 60 minutes.

ZL60-Filter Self-rescuer

Protection Time: ≥ 60 minutes

Inhalation Resistance: ≤ 275 Pa (flow rate 30 L/min)

Expiratory Resistance: ≤ 98 Pa (flow rate 30 L/min)

Inhalation Temperature: $\leq 60^{\circ}\text{C}$

Breaking Forces of Sealing Strip : 39-118 N

Filter Removal Force: ≤ 98 N



► Precautions for Use

1. This self-rescuer is for single use only. It must be discarded and not reused if the seal strip of the red lever is broken.

2. In an emergency, don the self-rescuer quickly while simultaneously planning your evacuation route. Choose the path that allows the easiest access to a safe area.

3. While escaping along the evacuation route, remain calm, avoid speaking (use gestures if necessary), and refrain from running. Running increases breathing resistance—the faster you run, the greater the resistance.

4. When used in a carbon monoxide (CO) environment, the air entering the user's mouth may feel hot and dry. This indicates the self-rescuer is working effectively and is normal. The temperature of the inhaled air depends on the CO concentration—higher concentrations result in higher temperatures. Do not remove the self-rescuer due to discomfort from the heated air. In such conditions, removing the device and taking even a single breath of untreated air can be fatal.

5. During escape, ensure the nose clip is not dislodged. If it comes off, avoid inhaling through your nose and quickly reattach the clip.

6. This self-rescuer is designed solely for escape purposes and must not be used for exploration or any other work.



► **Introduction**

LED wick, aluminum alloy light cup. Low beam, high beam, SOS flashing emergencylights.

SP-1/SP-2-Multi-purpose high-intensity flashlight Ⓞ

■ **Product parameter**

 <p>18cm</p> <p>4.7cm</p>	<p>Model: SP-1 Battery Capacity: 2000mAh Rated Voltage: 3.7V Continuous Discharge: 3h High Light Current: 700mA Weak Light Current: 250mA Light Source Power: 3W Light Brightness: 13700 Lux Main Light Source Operating Life:100000h Battery Recharge Times: 800 Charge Time: 4h Weight: 280g</p>	<p>25cm</p>	 <p>4.7cm</p>	<p>Model: SP-2 Battery Capacity: 4400mAh Rated Voltage: 3.7V Continuous Discharge: 3h High Light Current: 700mA Weak Light Current: 250mA Light Source Power: 3W Light Brightness: 13700 Lux Main Light Source Operating Life:100000h Battery Recharge Times: 800 Charge Time: 8h Weight: 360g</p>
--	---	-------------	--	---



High Bright



Low brightness mode



Low brightness mode

► **Introduction**

LED wick, aluminum alloy light cup. Low beam, high beam, SOS flashing emergencylights.

SP-3/SP-4 Multi-purpose high-intensity flashlight Ⓞ

■ **Product parameter**

 <p>16cm</p> <p>3.3cm</p>	<p>Model: SP-3 Battery Capacity: 2 *1.5V dry cell batteries Illuminance (Main/Sub): 1800 Operating Current (Main/Sub): 190 mA Operating Time (Main/Sub): >15 hours Main LED Power (W): 3 Weight (g): 121 Battery Type: AA dry cell batteries Battery Rated Voltage (V): 1.5 Lamp Housing Material: PA Light Cup Material: PA Rating: IP65</p>	<p>18cm</p>	 <p>4.7cm</p>	<p>Model: SP-4 Battery Capacity: 3*1.5V dry cell batteries Illuminance (Main/Sub): 3400 Operating Current (Main/Sub): 300mA Operating Time (Main/Sub): >10 hours Main LED Power (W): 3 Weight (g): 192 Battery Type: AA dry cell batteries Battery Rated Voltage (V): 1.5 Lamp Housing Material: PC Light Cup Material: PC Rating: IP65</p>
--	---	-------------	--	---



High Bright



Low brightness mode



Low brightness mode



Principle Introduction

Metal-air batteries are electrochemical energy devices that utilize metal as the anode and oxygen from the air as the cathode active material to generate electricity. In these batteries, metals undergo oxidation reactions to release electrons, while oxygen at the cathode accepts electrons and reacts with water to form hydroxide ions. This process generates current to power various devices.

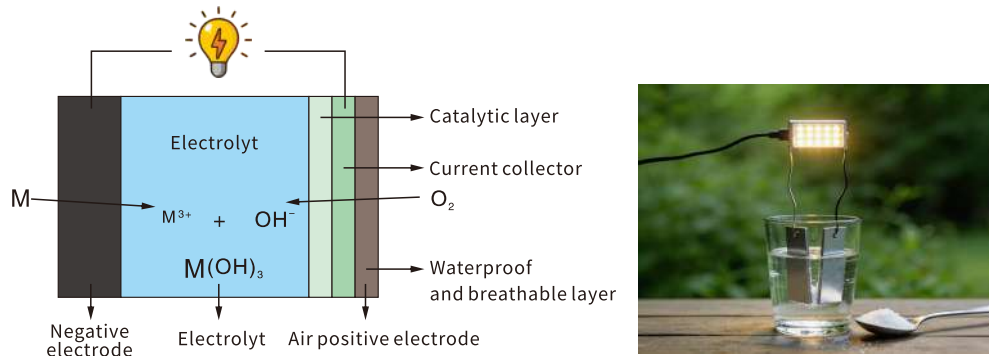

Advantages of Metal-Air Batteries

Metal-air batteries are a promising new battery technology with significant advantages, including:

- **High energy density:** Provides 1,300-2,000 Wh/kg, much higher than traditional lithium-ion batteries, storing more energy at the same weight.
- **High safety:** Uses aqueous electrolyte, non-flammable and non-explosive, safer than traditional batteries.
- **Fast energy replenishment:** Just replace the aluminum plate to quickly replenish energy, as easy as refueling, suitable for rapid power recovery.

These features give it significant advantages in lightweight and long-endurance, and it can be widely used in high power energy storage, electric vehicles, etc., promising to be the next-generation battery technology.

Metal Energy Storage Cycle Applications

The electrolysis process converts photovoltaic and other renewable energies into aluminum plates to store energy. During use, the chemical energy of aluminum plates is converted back into electrical energy via oxidation for equipment. Afterwards, aluminum plates can be recycled and reused, forming a closed loop from energy storage to release and enabling efficient recycling of green energy.

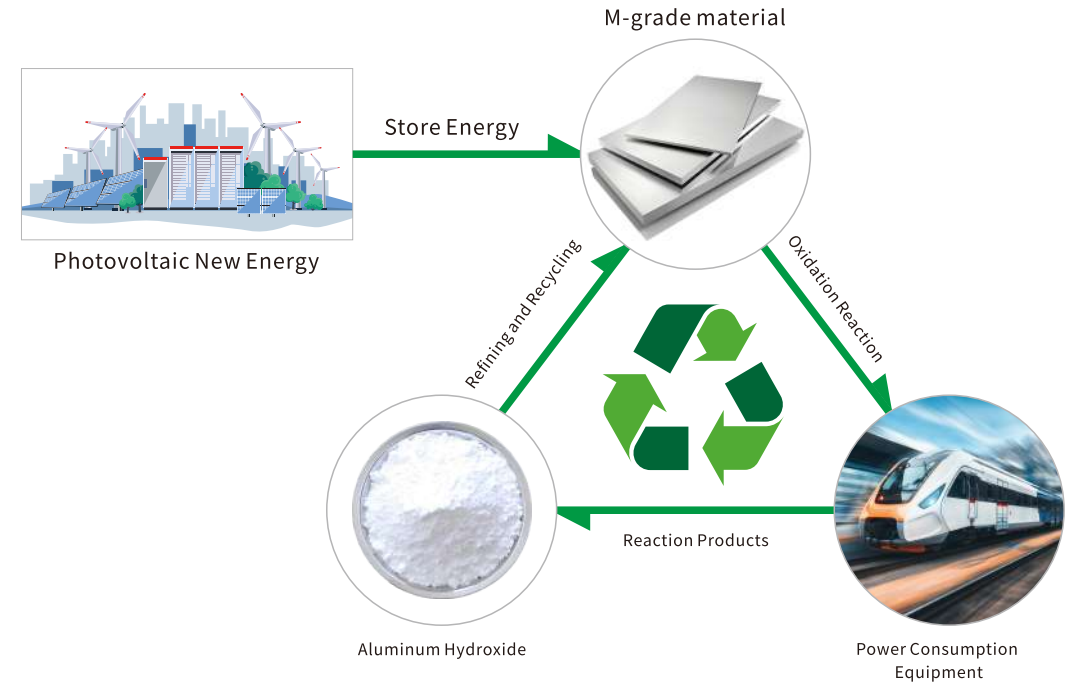

► Introduction

A compact and portable magnesium air battery lantern that's easy to use. With its ultra-long battery life and exceptional storage time, it's suitable for a variety of scenarios, especially for emergency lighting needs, making it an ideal disaster response solution.

Compact and lightweight design: Lightweight and easy to use.

Extremely long battery life: Long-lasting lighting, safe and explosion-proof.

Wide Applicability: Suitable for various lighting scenarios.

Extremely long storage life: Storage period exceeds 10 years.

Long-lasting lighting: Continuous lighting for over 72 hours, making it an ideal emergency lighting solution for disaster areas.

Z50-Waterproof light

Net weight: 20g

Size: 76×30×14mm

Battery life: >72 hours

Brightness: 6 lumens



► Introduction

A compact and portable magnesium air battery lantern that's easy to use. With its ultra-long battery life and exceptional storage time, it's suitable for a variety of scenarios, especially for emergency lighting needs, making it an ideal disaster response solution.

Compact and lightweight design: Lightweight and easy to use.

Extremely long battery life: Long-lasting lighting, safe and explosion-proof.

Wide Applicability: Suitable for various lighting scenarios.

Extremely long storage life: Storage period exceeds 10 years.

Long-lasting lighting: Continuous lighting for over 72 hours, making it an ideal emergency lighting solution for disaster areas.

Z50PRO-Waterproof light

Net weight: 32 ± 2g

Size: 34×20×80mm

Lighting time: 120h at low brightness

Brightness: 1700lux for 10h,

150lux for 120h

Color: BOZZYS Red



► Introduction

A magnesium-air battery flashlight features high brightness and long battery life, suitable for various lighting needs. Its unique quantitative water supply design and PP membrane water-repellent film ensure stability, cleanliness and hygiene, and it's safe to use with no fire risk.

Combining modern technology and portable design, this flashlight not only provides an efficient lighting solution but also ensures users' safety and convenience. Whether for exploration, camping or home emergencies, it's an ideal choice.

Quantitative water supply design: Ensures stable battery reaction and improves safety.

PP membrane water-repellent film: Prevents water leakage for clean and hygienic use.

No open flame safety: Safe to use with no fire risk.

Z500-Water - resistant Flashlight

Net weight: 200g

Size: $\Phi 50 \times 187$ mm

Battery life: >30 hours

Brightness: 3200 lumens

Colors: Desert yellow, black



► Introduction

Foldable storage aluminum air battery pocket light provides high-brightness illumination, long battery life, and no heavy metal pollution. Combining a lightweight design with high-efficiency lighting, this aluminum air battery light not only delivers excellent performance but also balances environmental protection and user convenience. Whether for home backup or outdoor adventures, it provides a reliable light source.

Lightweight: Easy to carry for various travel and outdoor activities.

Foldable storage: Small in size, space-saving, easy to store and carry.

Brightness: Provides clear, bright light to meet your lighting needs.

Long battery life: Ensures long-lasting lighting time.

Environmentally friendly: Free of heavy metal pollutants, ensuring peace of mind.

YS-S01-Water Activated Lamp

Net weight: 50g

Size: $120 \times 195 \times 60$ mm

Lighting time: ≥ 120 h

Brightness: 45lm

Salt water concentration: 3.5% - 2

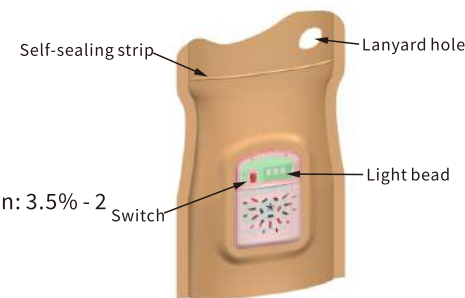

► Introduction

A metal-air battery water-activated candle for scenarios such as firefighting, outdoor, emergency, home, and ambiance lighting. It illuminates by adding saltwater, requires no maintenance during storage, and is easy and simple to operate. The product features ultra-long endurance and an ultra-long storage life, making it suitable for various sudden emergency situations requiring lighting during power outages. It is an ideal disaster/emergency lighting solution.

BSZM-AZ-LZ01-Water-Activated Candle Lamp

Dimensions: Diameter 3 inches, Height 6 inches

Saltwater concentration/volume: 10±1% / 300±10ml

Lighting time: Single use <5h; 50-200ml

Storage time: >5 years

Operating temperature: 0 - +55°C

Storage temperature: -20 - +85°C

Relative humidity: 5% - 95%

(non-condensing, salt-free environment)

Altitude range: 2000m and below



Usage

- 1: Lift and remove the lamp head to separate it from the lamp body.
2. Add 30g of salt granules or seawater into the lamp body, and add water up to the internal reinforcing rib line (boss, do not exceed the maximum water level).
3. Shake the lamp body to dissolve the salt granules.
4. Reattach the lamp body to the lamp head, and it will illuminate (wait 30s).
5. (Replacing the aluminum plates): Pull out the 2 aluminum plates downwards; replace with new aluminum plates and insert them upwards to complete the installation.

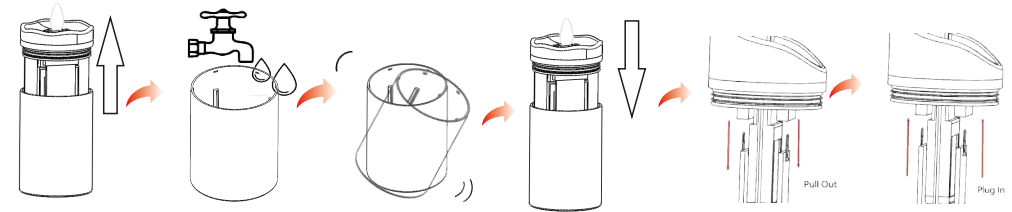

► Introduction

A metal-air battery water-activated candle for scenarios such as firefighting, outdoor, emergency, home, and ambiance lighting. It illuminates by adding saltwater, requires no maintenance during storage, and is easy and simple to operate. The product features ultra-long endurance and an ultra-long storage life, making it suitable for various sudden emergency situations requiring lighting during power outages. It is an ideal disaster/emergency lighting solution.

BSZM-AZ-LZ05~7-Candle Lamp / Ambiance Lamp

Dimensions: Diameter 3 inches, Height 4-7 inches

Saltwater concentration/volume: $(3.5-10) \pm 1\%$ / $300 \pm 10\text{ml}$

Lighting time: Programmed: 6h on, 18h off (>20 days)

Storage time: >5 years

Operating temperature: $0 \sim +55^{\circ}\text{C}$

Storage temperature: $20 \sim +85^{\circ}\text{C}$

Relative humidity: 5% - 95%

(non-condensing, salt-free environment)

Altitude range: 2000m and below



Usage

- 1: Lift and remove the lamp head to separate it from the lamp body.
2. Add 30g of salt granules or seawater into the lamp body, and add water up to the internal reinforcing rib line (boss, do not exceed the maximum water level).
3. Shake the lamp body to dissolve the salt granules.
4. Reattach the lamp body to the lamp head, and it will illuminate (wait 30s).
5. (Replacing the aluminum plates): Pull out the 2 aluminum plates downwards; replace with new aluminum plates and insert them upwards to complete the installation.

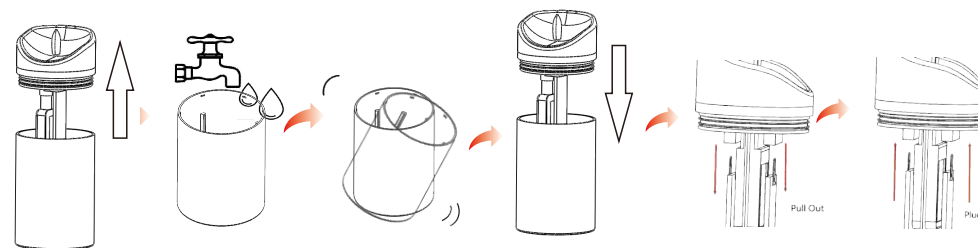

► **Introduction**

A high-brightness aluminum-air battery lamp with replaceable consumables for repeated use, suitable for lighting in power-scarce areas and emergency lighting reserves. Innovative features: Dual-chamber design: can be stored with electrolyte

Innovative double-cavity design: Can hold electrolyte.

S6-Water Activated Lamp ➤

- Net weight: 350g
- Size: 103×103×133mm
- Brightness: 100lm
- Lighting time: ≥24h
- Salt water concentration: 3.5% - 25%

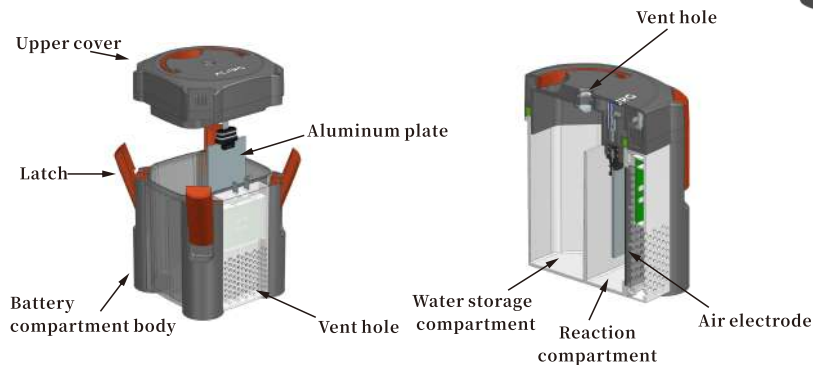

► **Introduction**

A high-performance, water-repellent, multi-functional lighting fixture with replaceable consumables: 360° circular illumination

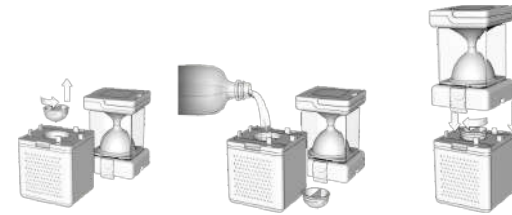

S30-Water Activated Lamp ➤

- Net weight: 580g
- Size: 238×95×95mm
- Power: 3W
- Salt water concentration: 7% - 10%
- Charging endurance: 3 - 8 times (related to mobile phone capacity)
- Lighting endurance: 72H at high brightness / 700H at low brightness
- Floodlight endurance: 75H at high brightness / 750H at low brightness
- Power: 60wh
- Interfaces: 1 USB-A, 1 DC2.6mm

Applicable scenarios



For outdoor hiking



For power outage



► **Introduction**

A metal-air power source with lightweight, versatile, long shelf life, large capacity, and environmentally friendly features. Combining the characteristics of a mobile power source with a metal-air battery, it offers high performance, environmental friendliness, and portability, providing a long-term, stable power supply.

Eco-friendly: No pollution

Ultra-long storage: Up to 10 years.

SP20W- Emergency Power Pack ◀▶

- Stable power: 20W
- Rated voltage: 5V
- Charging function: USB/TYPER-C
- Lighting time: 200lm, with steady-on and SOS flashing modes
- Radio: AM/FM
- Size: 230 × 115 × 184mm
- Capacity: 240Wh (with three times of liquid)
- Liquid replacement: Replaceable, about 0.9L per time
- Operating temperature range: 0°C - 40°C



► **Introduction**

A 5W water-activated metal-air mobile power supply, with light weight, strong universality, long storage time, and eco-friendliness.

This battery combines mobile power and metal-air battery power generation. It offers excellent performance, eco-friendliness, convenience, and long-term power supply.

Lightweight: 2/3 the weight of same-capacity batteries.

Eco-friendly: Pollution-free, degradable plastic.

Ultra-long storage: Over 10 years.

ZP5W-Self - Powered Portable Power Bank ◀▶

- Net weight: 220g
- Size: 65 × 65 × 110mm
- Power: 1A max
- Capacity: 30Wh
- Interface: USB - A 5V 1A max

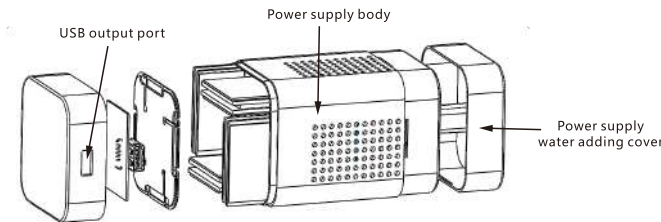

► **Introduction**

9V batteries for emergency supplies, flashlights, and radios.

Lightweight: Half the weight of batteries with the same capacity

Eco-friendly: Can be directly discarded after use.

Ultra-long storage time: Storage period is as long as 10 years.

Safe: Maintenance-free, no need for charging.

Hearing Aid Battery ➤

Rated voltage: 9V
 Size: 26×17×48mm
 Capacity: 2Wh
 Output current: 20mA

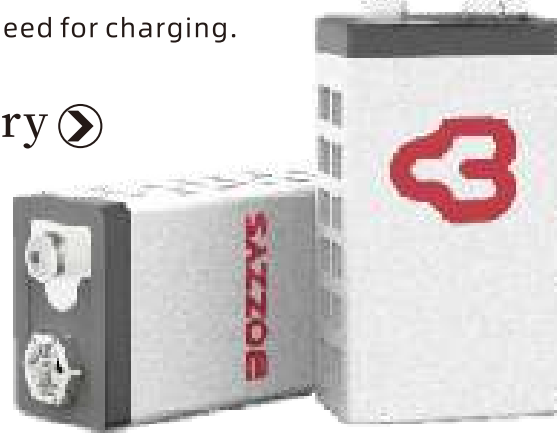

Electrical safety



Environmentally friendly



Long term storage

► **Introduction**

Batteries for hearing aids

Eco-friendly: Can be directly discarded after use

Ultra-long storage time: Storage period is as long as 10 years.

Safe: Maintenance-free, no need for charging, no voltage output when idle, and no attenuation.

Button Cell Battery ➤

Size: Diameter 11.6mm, Thickness 5.4mm
 Voltage: 6V
 Capacity: 0.4Wh
 Rated output current: 2.5mA



Electrical safety



Environmentally friendly



Long term storage

► Introduction

A disposable 50W metal-air portable power supply, with advantages of light weight, strong universality, long storage time, large portable power capacity, and environmental protection.

This battery combines the features of portable power supply and metal-air battery for power generation. It not only offers excellent performance but also considers environmental protection and convenience, and can provide long-term power supply.

Lightweight: Half the weight of same-capacity batteries.

Eco-friendly: Can be directly discarded after use.

Ultra-long storage: Up to 10 years.

Safe: Maintenance-free, no charging required.

SP50W-Portable power supply ➡

Power supply voltage: 6V

Size: 316×140×359mm

Capacity: 740Wh

Output power: 50W

Output voltage: 12V

Weight (excluding liquid): about 2700g

Metal plate specification: 2mm

Electrolyte type: salt-alkali water

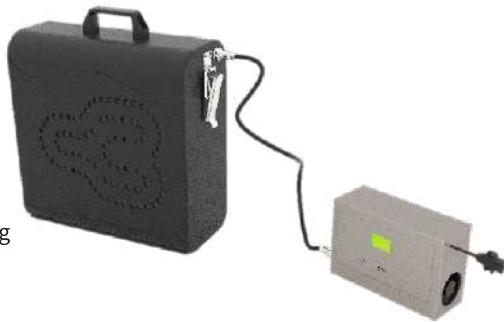

► Introduction

Fixed power supplies above 500W are mainly divided into: fixed standby power supplies and mobile standby power supplies.

AC220V/110V can be equipped with secondary lithium battery power supplies for voltage stabilization.

Features of this type of product: large storage capacity, no need for charging maintenance, long shelf life; can be used in combination with wind, light, lithium and other power sources

Ultra-long storage time: Storage up to 10 years, maintenance-free, no attenuation.

Compatible with wind/light/lithium: Fixed emergency, island energy storage, household emergency, communication backup, etc

Z500W-backup power supply ➡

Size: 316x140x359mm

Capacity: 740wh

Output power: 500-5000w

Output voltage: 12v, 24v, 48v, 72v

Weight: 800G



► Introduction

Suitable for night inspection lighting at police mobile checkpoints, patrol cars, emergency vehicles; emergency and firefighting frontline rescue, accident and disastersite lighting; traffic accident investigation and rescuescenes, and highway。

Checkpoint lighting; large-scale mobile lighting for emergency rescue in industries such as petroleum, chemical, railway, grid power, and construction sites in hazardous areas.

Compact size and lightweight, allowing for various carrying methods such as hand-held and backpack.

KYB1-LED180-Panoramic Explosion-Proof Mobile Lighting

Dimensions (folded): 200*222*1145mm

Dimensions (maximum height, raised): 780*4000mm

Output Power: 180W

Rated Voltage: DC22.2V

Battery Life: >500 cycles

Weight: 13 ± 1 kg



■ Technical Parameters

No.	Parameter Name	Unit	Value	
1	Rated Voltage	V	DC22.2	
2	Battery Rated Capacity	Ah	5x5	
3	Light Source (LED)	Rated Power	W	180
		Service Life	H	100000
		Max. Initial Illuminance at 10m (Strong Light)	LX	600
4	Lighting Type	/	Spotlight/Floodlight	
5	Warning Light Color	/	Red/Blue	
6	Lighting Time (Spotlight + Floodlight)	Strong Light	H	≥6
		Medium Light	H	≥9
		Working Light	H	≥12
7	Battery Service Life	cycles	>500	
8	Charging Time	H	<5	
9	Dimensions	Storage State	mm	200*222*1145(±20)
		Maximum rise highest	mm	780*4000(±20)
10	Weight	Kg	13±1	

► Introduction

Suitable for use as working lighting in police, military, firefighting, railway, electric power, oil field, petrochemical, petroleum, metallurgy, gas maintenance, industrial and mining enterprises, and various field work sites.

Portable design, adaptable to multiple scenarios:

Ultra-lightweight, significantly reducing the burden of long-distance carrying, suitable for scenarios requiring mobile operations such as outdoor inspections and emergency rescues.

KYB3-LED2x48 Multi-functional Elevating Work Light

Dimensions (folded):

485*340*720mm

Dimensions (maximum height, raised):

485*340*2300mm

Rated Voltage: 220v

Rated Power: 2*48w

Rated output voltage: 230VA 50Hz

Protection rating: IP65 (Lamp Head), IP54 (Case)



■ Technical Parameters

No.	Parameter Name	Unit	Value	
1	Rated Voltage	v	220V	
2	Rated Power	W	2*48	
3	Lamp Head (LED)	Average Life	h	≥5000
		Luminous Flux	lm	≥4000
4	Generator Set (IG770)	Rated Output Voltage	v	>3
		Continuous Operation Time	lx	>200
		Fuel Tank Capacity	angle	≥180
5	Dimensions	Operating Status (Lowered)	mm	485*340*720
		Operating Status (Raised)	mm	485*340*2300
6	Telescopic pole	Retracted Height	m	485*340*720
		Maximum rise highest	m	485*340*2300
7	Weight	KG	23	
8	Protection Rating	/	Ip65 (Lamp Head), IP54 (Case)	
9	Protection Rating	/	Wf2	

► Introduction

The AD6117 LED explosion-proof lightweight mobile light, developed by our company based on market needs, is mainly suitable for small-scale construction, maintenance, emergency rescue lighting in flammable and explosive places such as refineries, chemical plants, and oil fields. It can be used safely in various flammable and explosive environments.



KYB4-WJ45- Explosion-Proof Lightweight Mobile Light

Dimensions (contracted state): 500*150*180mm

Dimensions (extended state): 500*150*1280mm

Rated Voltage: DC22V

Rated Capacity: 5*2 (group) Ah

Weight: 6Kg

Operating Environment: -20~40°C

Protection rating: IP66



■ Technical Parameters

No.	ParameterName	Unit	Value	
1	BatteryRatedVoltage	v	Dc22	
2	BatteryRatedCapacity	Ah	5*2(group)	
3	Rated power	w	50	
4	Light Source	Average Life	h	100000
		Color Temperature	k	5000-6000
5	Lighting Angle	Horizontal Direction	Angle	0~360
		Vertical Direction	Angle	0~135
6	Lighting type	/	Spotlight/Floodlight	
7	Strong Light Continuous Lighting Time	h	≥10	
8	Continuous Lighting Time	h	≥16	
9	Charger Input Voltage	v	AC100-220	
10	Warning Light Color	/	Red/Blue	
11	Battery Service Life	cycles	≥500	
12	Charging Time	h	<16	
13	Dimensions	Storage State	mm	500*150*180
		Extended State	mm	500*150*1280
14	Weight	Kg	6	
15	Operating Environment	°C	-20~40	
16	Protection Rating	/	IP66	

► Introduction

Suitable for small-scale maintenance and construction lighting in railway works, signaling & communication, power supply, transportation departments, etc. Also suitable for small-scale emergency lighting in power grids, public security, and other industries.

Flexible and versatile lighting forms: The lamp has dual-use forms. It can be used as fixed lighting equipment by raising the telescopic pole, providing continuous and stable lighting for a large area.

KYB5-LED35- LED Lightweight Mobile Light

Dimensions (contracted state): 510*290*220mm

Dimensions (extended state): 510*290*1500mm

Rated Voltage: DC21.6V

Rated Capacity: 5*2 (group) Ah

Battery Service Life: approx. 100h

Weight: <8Kg



■ Technical Parameters

No.	Parameter Name	Unit	Value	
1	Battery Rated Voltage	V	Dc21.6	
2	Battery Rated Capacity	Ah	13	
3	Light Source	Service life	h	100000
		Rated power	W	35
4	Lighting type	/	Spotlight/Floodlight	
5	Dim mode	/	100%-100% Stepless Dimming	
6	Warning light color	/	Red/Yellow	
7	Continuous lighting time	h	>8	
8	Charging time	h	<6	
9	Battery life	cycles	approx:100	
10	Dimensions	Storage state	mm	510*290*220
11		Extended State	mm	510*290*1500
12	Weight	Kg	<8	
13	Protection Rating	/	IP65 (Lamp Head), IP54 (Case)	

► Introduction

Suitable for night inspection lighting at police mobile checkpoints, patrol cars, emergency vehicles; emergency and firefighting frontline rescue, accident and disastersite lighting; traffic accident investigation and rescuescenes, and highway.

Checkpoint lighting: large-scale mobile lighting for emergency rescue in industries such as petroleum, chemical, railway, grid power, and construction sites in hazardous areas.

Protection Rating: IP66

Explosion-proof Mark: Ex eb ib mb IIC T6 Gb

KYB2-LED100-120-Panoramic Explosion-Proof Mobile Lighting

Dimensions (telescopic pole contracted):

Φ205 × 865mm

Dimensions (telescopic pole extended):

Φ780 × 2320mm

Output Power: 180W

Rated Voltage: DC22.2

Battery Service Life: cycles >1000

Weight: 8±0.5kg



■ Technical Parameters

No.	ParameterName	Unit	Value
1	Rated Voltage	V	DC22.2
2	Battery Rated Capacity	Ah	3x5
3	Rated Power	W	100~120
4	Max. Initial Illuminance at 10m (Strong Light)	Strong Light	LX 750
		Medium Light	LX 450
		Working Light	LX 300
5	Lighting type	/	Spotlight/ Floodlight
6	Warning light color	/	Yellow
7	Lighting Time (Floodlight+Spotlight)	Strong Light	H 5
		Medium Light	H 10
		Working Light	H 14
8	Battery life	cycles	>1000
9	Charging time	H	<6
10	Dimensions	Telescopic Pole Contracted State	MM φ205x865(±50)
		Telescopic Pole Extended State	MM φ780x2320(±50)
11	Weight	Kg	8±0.5
12	Operating Environment	°C	-20~40
13	Protection Rating	/	IP66
14	Wind Resistance Rating	/	6

► Introduction

Provides mobile lighting for railways, electric power, public security, accident emergency repair, abnormal situation handling, outdoor mobile night emergency lighting, and other worksites.

Core advantages of light source and endurance: Empowered by top-tier LED light source, ultra-long high endurance covers all scenario needs. With international top-level LED, low power consumption achieves long-lasting lighting: 8 hours of strong light, 16 hours of working light.

KYB8-LED2x60- Portable Elevating Work Light

External Dimensions: 1200*150*2300mm

Rated Voltage: 21V

Rated Capacity: 10Ah

Weight: 6.6Kg

Rated Power: 60W

Luminous Flux: 4800lm



■ Technical Parameters

No.	Parameter Name	Unit	Value	
1	Rated Voltage	V	21	
2	Rated Capacity	Ah	10	
3	LEDBulb	Working Voltage	v	24/36
		Rated Power	w	2*60
		Luminous Flux	lm	4800
		Average Service Life	h	100000
4	Spotlight/Floodlight Continuous Discharge Time	Strong Light	h	8
		Working Light	h	16
5	Spotlight/Floodlight Continuous Discharge Duration	Spotlight	h	16
		Floodlight	h	12
6	Charging Time	After Normal Use	h	8
		When Battery is Depleted	h	≤10
7	Battery Service Life	cycles	1000	
8	Dimensions	Length	mm	1200
		Width	mm	150
		Maximum rise highest	mm	2300
9	Weight	Kg	6.6	

► Introduction

Provides mobile lighting for railways, electric power, public security, accident emergency repair, abnormal situation handling, outdoor mobile night emergency lighting, and other worksites.

Core advantages of light source and endurance: Empowered by top-tier LED light source, ultra-long high endurance covers all scenario needs. With international top-level LED, low power consumption achieves long-lasting lighting: 8 hours of strong light, 16 hours of working light.

KYB7-LED60- Portable Elevating Work Light

External Dimensions: 1130*135*2300mm

Rated Voltage: 21V

Rated Capacity: 10Ah

Weight: 6.6Kg

Rated Power: 60W

Luminous Flux: 6000lm



■ Technical Parameters

No.	ParameterName		Unit	Value
1	RatedVoltage		V	21
2	RatedCapacity		Ah	10
3	LED Bulb	WorkingVoltage	V	24v/36v
4	Rated Power		w	60
5	Luminous Flux		lm	6000
6	Spotlight/ Floodlight Continuous Discharge Time	Strong Light	h	8
		Working Light		16
7	Spotlight/ Floodlight Continuous Discharge Duration	Spotlight	h	16
		Floodlight		
8	12 H of charging	Normal use	h	8
9	When Battery is Depleted		h	<10
10	Battery Service Life		cycles	Approximately 1000
11	Dimensions		mm	1130*135*2300
11	Weight		Kg	6.6

► Introduction

Provides mobile lighting for railways, electric power, public security, accident emergency repair, abnormal situation handling, outdoor mobile night emergency lighting, and other worksites.

Core advantages of light source and endurance: Empowered by top-tier LED light source, ultra-long high endurance covers all scenario needs. With international top-level LED, low power consumption achieves long-lasting lighting: 8 hours of strong light, 16 hours of working light.

KYB6-LED27- Explosion-Proof Strong Light Work Light

External Dimensions: 300*251*880mm

Rated Voltage: 14.8V

Rated Capacity: 10Ah

Working Voltage: 12V

Rated Power: 27W

When Battery Depleted: 10h

Luminous Flux: 3800lm

Weight: 8Kg



■ Technical Parameters

No.	ParameterName	Unit	Value	
1	RatedVoltage	V	14.8	
2	RatedCapacity	Ah	10	
3	LEDLight Source	WorkingVoltage	V	8
		RatedPower	w	27
		LuminousFlux	lm	3800
4	AverageServiceLife	h	100000	
5	Continuous Discharge Time	StrongLight	h	10
		WorkingLight		20
		strobelight		50
6	ChargingTime	Normaluse	h	8
7	WhenBatteryisDepleted	h	10	
8	BatteryServiceLife	cycles	2000	
9	Dimensions	mm	300*251*880	
10	Weight	Kg	8	

► Introduction

Provides mobile lighting for high-brightness large-area night lighting and other work sites during on-site operations, accident emergency repairs, abnormal situation handling in various flammable and explosive places for units such as railways, electric power, public security, military, ships, and petrochemicals.

Flexible lighting and intelligent endurance monitoring: The lamp head can be adjusted at multiple angles, eliminating lighting blind spots and improving work efficiency.

KYB9-LED27- Lightweight Mobile Light

Dimensions: 252*198*640mm

Rated Voltage: 14.8V

Rated Capacity: 10Ah;

Bulb: Working Voltage 12V

Power: 27W

Luminous Flux: 3200lm

Continuous Service Life: >100000 h

Continuous Discharge: Strong Light: 9h, Working Light: 16h

Charging Time: Normal Use: 8h, When Battery Depleted: >10h

Battery Service Life: approx. 1000 (cycles);

Weight: 6.5kg



■ Technical Parameters

No.	ParameterName	Unit	Value	
1	RatedVoltage	V	14.8	
2	RatedCapacity	Ah	10	
3	LED Light Source	WorkingVoltage	V	12
		RatedPower	w	27
		LuminousFlux	lm	3200
4	AverageServiceLife	h	100000	
5	Continuous Discharge Time	StrongLight	h	9
		WorkingLight		16
6	ChargingTime	Normal use	h	8
7	When Battery is Depleted		h	10
8	Battery Service Life	cycles		1000
9	Dimensions	mm		252*198*640
10	Weight	Kg		6.5

► Introduction

Troops, railways, electric power, public security, petrochemical and other units provide mobile lighting for various on-site operations, emergency repairs, abnormal situation handling, and other workplaces requiring high-brightness, large-area nighttime illumination.

Centralized Charging: Built-in unified charging circuit supports simultaneous charging of all lights.

Multi-Function Use: Integrates storage, transportation, and charging functions into one unit.

KYB58-Portable High-Intensity Lighting Set

External Dimensions: 225*85mm

Rated Battery Voltage: DC12

Rated Battery Capacity: 6600 mAh

Rated Power: 35~70W

Weight: 1.58kg

Operating Environment: -20 ~ 40°C

Protection Rating: IP68



■ Technical Parameters

No.	ParameterName	Unit	Value
1	InputVoltage	V	AC220VDC9-30V
2	USBOutput	A	6*DC5V3A DC9V2A DC12V1.5A
3	ChargingOutputMethod		NumberofLamps ChargedviaChargingPort
4	NumberofLampsCharged viaChargingPort	Set	5
5	Type-CChargingPort	A	5*DC5V 2A
6	NumberofDocking StationInterfaces	Number	5
7	Cartonsize	mm	860x610x380mm
8	Weight	Kg	50kg(includinglamps)

► **Introduction**

Features three lighting modes: strong light, working light, and low light, switchable with one button. The light irradiation angle can be adjusted by rotating the lamp head and handle. Spotlight and floodlight are adjustable. Features a yellow warning light function. The lamp has a universal USB charging port for quickly charging mobile phones or other electronic devices, and is equipped with real-time battery level monitoring and display function to keep track of the remaining battery power and usage time at any time.

KYB10-LED12-Portable Multi-functional Strong Light ➤

External Dimensions: 171*156*208mm

Battery Rated Voltage: 11.1V

Battery Rated Capacity: 5Ah

Rated Power: 12W

Weight: 1.8kg

Light Source: Imported CREE

Battery Used: 18650 Lithium Battery

Other Functions: With magnetic attachment function

Charging: DC

Discharge Time: Strong Light >10h; Working Light >24h



■ **Technical Parameters**

No.	ParameterName	Unit	Value
1	Rated Power	V	12
2	Rated Voltage	V	11.1
3	Average Service Life	h	100000
4	Continuous Discharge Time	Strong Light	>10
		Working Light	>24
5	Battery Used	Lithium	18650
6	Dimensions	mm	171*156*20
7	Weight	Kg	1.8

► Introduction

Features three lighting modes: strong light, working light, and low light, switchable with one button. The light irradiation angle can be adjusted by rotating the lamp head and handle. Spotlight and floodlight are adjustable. Features a yellow warning light function. The lamp has a universal USB charging port for quickly charging mobile phones or other electronic devices, and is equipped with real-time battery level monitoring and display function to keep track of the remaining battery power and usage time at anytime

KYB11-LED3x3-Portable Multi-functional Strong Light

External Dimensions: 151*131*272mm

Rated Power: 3*3W

Light Source: Imported CREE

Service Life: 100000h

Battery Used: 18650 Lithium Battery

Lighting Modes: 2 levels - Strong Light, Low Light

Other Functions: With magnetic attachment function

Charging: Direct Charging

Discharge Time: Strong Light >7h, Low Light >14h



LCD High-Power Searchlight

■ Technical Parameters

No.	ParameterName	Unit	Value
1	Rated Power	w	3*3
2	Rated Voltage	V	11.1
3	Capacity	Ah	4
4	Average Service Life	h	100000
5	Continuous Discharge Time	Strong Light	>7
		Low Light	>14
6	Battery Used	Lithium	18650
7	Dimensions	mm	151*131*272
8	Weight	Kg	1.45

► Introduction

This system integrates 360-degree panoramic illumination with explosion-proof safety design, providing a full-coverage, high-safety mobile lighting solution for hazardous environments such as petroleum, chemical plants, and mines. It is waterproof, dustproof, and impact-resistant, widely used in emergency rescue, equipment maintenance, and field operations.

KYBZB-LED120-Panoramic Explosion-Proof Portable Lighting System

Rated voltage:DC22.2V

Battery rated capacity:3*5Ah

Rated power:100~120W

Warning light color:red/blue

Charge time:<6h

Weight:8.5kg

External dimensions:

Lifting rod in retracted state:φ200x1035mm

Lifting in extended state:φ780x2390mm

Waterproof rating:IP67

Wind resistance rating:6



■ Technical Parameters

No.	ParameterName	Unit	Value
1	Rated Voltage	V	DC22.2
2	Battery Rated Capacity	Ah	3x5
3	Rated Power	W	100~120
4	Max. Initial Illuminance at 10m (Strong Light)	Strong Light	LX 750
		Medium Light	LX 450
		Working Light	LX 300
5	Lighting type	/	Spotlight/ Floodlight
6	Warning light color	/	Red and Blue
7	Lighting Time (Floodlight+Spotlight)	Strong Light	H 5
		Medium Light	H 10
		Working Light	H 14
8	Battery life	cycles	>1000
9	Charging time	H	<6
10	Dimensions	Telescopic Pole Contracted State	MM φ200*1035
		Telescopic Pole Extended State	MM φ780*2390
11	Weight	Kg	8±0.5
12	Operating Environment	°C	-20~40
13	Protection Rating	/	IP67
14	Wind Resistance Rating	/	6

► Introduction

Product Introduction/Introduction The lamp head spotlight has three levels: strong light, working light, and strobe, freely switchable by lightly pressing the main switch. The side light has floodlighting and red/blue warning functions, freely switchable by lightly pressing the small switch. The lamp has a battery level display and a low battery warning function. It also features color temperature adjustment.

KYB12-LED2x12-Multi-functional Explosion-Proof Handheld Light

External Dimensions: 190*70mm

Rated Power: 2*12W / 6W

Light Source: Imported CREE, Service Life: 100000h

Battery Used: 18650 Lithium Battery

Lighting Modes: 3 levels - Low Light, Strong Light Touch Switch

Charging: DC

Discharge Time: Strong Light >5h; Working Light >10h



■ Technical Parameters

No.	ParameterName	Unit	Value
1	Rated Power	w	2*12w/6w
2	Rated Voltage	V	22.2
3	Capacity	Ah	2.5
4	Average Service Life	h	100000
5	Continuous Discharge Time	Strong Light	>5
		Working Light	>10
6	Battery Used	Lithium	18650
7	Dimensions	mm	190*70
8	Weight	Kg	0.9

► Introduction

The multi-functional explosion-proof handheld light is a portable lighting tool specifically designed for flammable, explosive, high-risk, and complex environments. It is widely used in scenarios such as mines, chemical plants, oil fields, electric power maintenance, and fire rescue. It features explosion-proof, waterproof, drop-resistant, and long-endurance characteristics, ensuring safe and reliable use under extreme conditions.

KYB13-LED10/5-LED Lightweight Work Light

External Dimensions: 190*70mm

Rated Power: 2*12W / 6W

Light Source: Imported CREE, Service Life: 100000h

Battery Used: 18650 Lithium Battery

Lighting Modes: 3 levels - Low Light, Strong Light, Touch Switch

Charging: DC

Discharge Time: Strong Light >5h; Working Light >10h



■ Technical Parameters

No.	ParameterName	Unit	Value
1	Rated Power	w	2*12w/6w
2	Rated Voltage	V	22.2
3	Capacity	Ah	2.5
4	Average Service Life	h	100000
5	Continuous Discharge Time	Strong Light	>5
		Working Light	>10
6	Battery Used	Lithium	18650
7	Dimensions	mm	190*70
8	Weight	Kg	0.9

► Introduction

The lightweight multi-functional strong light explosion-proof searchlight is a high-performance lighting tool designed for high-risk and complex environments. It is suitable for flammable, explosive, or extreme working condition scenarios such as petroleum, petrochemical, electric power, metallurgy, mines, and railway maintenance. While ensuring high brightness and long range, this type of lamp features explosion-proof, waterproof, drop-resistant, long endurance, and multiple usage methods, ensuring safe and efficient operation.

KYB15-LED9-Multi-functional Strong Light Explosion-Proof Searchlight

External Dimensions: 165*145*270mm

Rated Power: 9W

Voltage: 11.1V

Capacity: 4Ah

Light Source: Imported CREE

Service Life: 100000h

Battery Used: 18650 Lithium Battery:

2 levels - Energy-saving Light, Strong Light

Charging: DC

Discharge Time: Strong Light >8h; Energy-saving Light >24h

Other Functions: With magnetic attachment function

Weight: 2kg



■ Technical Parameters

No.	ParameterName	Unit	Value
1	Rated Power	w	9
2	Rated Voltage	V	11.1V
3	Capacity	Ah	4
4	Average Service Life	h	100000
5	Continuous Discharge Time	Strong Light	>8
		Energy-saving Light	>24
6	Battery Used	Lithium	18650
7	Dimensions	mm	165*145*270
8	Weight	Kg	2

► Introduction

The lightweight multi-functional strong light explosion-proof searchlight is a high-performance lighting tool designed for high-risk and complex environments. It is suitable for flammable, explosive, or extreme working condition scenarios such as petroleum, petrochemical, electric power, metallurgy, mines, and railway maintenance. While ensuring high brightness and long range, this type of lamp features explosion-proof, waterproof, drop-resistant, long endurance, and multiple usage methods, ensuring safe and efficient operation.

KYB16-LED12-LED Lightweight Work Light

External Dimensions: 165*145*270mm

Rated Power: 12W

Voltage: 11.1V

Capacity: 10Ah

Light Source: Imported CREE

Service Life: 100000h

Battery Used: 18650 Lithium Battery

Lighting Modes: 2 levels - Energy-saving, Strong Light

Charging: DC

Discharge Time: Strong Light >8h; Energy-saving Light >24h

Other Functions: With magnetic attachment function

Weight: 2kg



■ Technical Parameters

No.	ParameterName	Unit	Value
1	Rated Power	w	12
2	Rated Voltage	V	11.1
3	Capacity	Ah	10
4	Average Service Life	h	100000
5	Continuous Discharge Time	Strong Light	>8
		Energy-saving Light	>24
6	Battery Used	Lithium	18650
7	Dimensions	mm	165*145*270
8	Weight	Kg	2

► **Introduction**

The lightweight multi-functional strong light explosion-proof searchlight is a high-performance lighting tool designed for high-risk and complex environments. It is suitable for flammable, explosive, or extreme working condition scenarios such as petroleum, petrochemical, electric power, metallurgy, mines, and railway maintenance. While ensuring high brightness and long range, this type of lamp features explosion-proof, waterproof, drop-resistant, long endurance, and multiple usage methods, ensuring safe and efficient operation.

KYB17-LED13-LED Lightweight Work Light 

External Dimensions: 165*145*270mm

Rated Voltage: 14.8V

Capacity: 4.4Ah

Service Life: 100000h

Lighting Modes: 2 levels - Energy-saving Light, Strong Light

Charging: Direct Charging

Discharge Time: Strong Light ≥8h; Working Light ≥16h

Weight: 1.45kg

Explosion-proof Grade: ExdIICT6

Protection Rating: IP65



■ **Technical Parameters**

No.	ParameterName	Unit	Value
1	RatedVoltage	V	14.8
2	RatedCapacity	Ah	4.4
3	LightSource(LED)Power	W	13
4	StrongLightLuminousFlux	lm	10
5	AverageServiceLife	h	≥100000
6	Continuous Discharge Time	StrongLight	≥8
		WorkingLight	≥16
7	BatteryServiceLife	cycles	≥2000
8	Dimensions	mm	160*130*270
9	Weight	Kg	1.45

► **Introduction**

The squad-use strong light searchlight is a high-performance lighting tool designed for scenarios such as field operations, emergency rescue, inspection and maintenance. It features high brightness, long endurance, multi-mode lighting, and strong environmental adaptability. It is widely used in multiple industrial and security fields such as individual soldier operations, flood control and emergency rescue, electric power emergency repair, and metallurgical inspection.

**KYB18-LED3x3-Squad-Use
Strong Light Searchlight** ➤

External Dimensions: 200*90*100mm

Rated Voltage: 7.4V

Capacity: 6Ah

Service Life: 100000h

Lighting Modes:

Strong Light - Working Light - Low Light - Flashing

Light Source: Imported CREE

Discharge Time: High Light >9h; Low Light >16h

Weight: 0.75kg

Other Functions: With magnetic attachment function



■ **Technical Parameters**

No.	ParameterName	Unit	Value
1	RatedVoltage	V	7.4
2	RatedCapacity	Ah	6
3	Rated Power	W	3.3
4	Continuous Discharge Time	High Light	≥8
		Low Light	≥16
5	Dimensions	mm	200*90*100
6	Weight	Kg	0.75

► Introduction

The handheld searchlight is a high-brightness, long-range portable lighting tool, widely used in scenarios such as outdoor exploration, emergency rescue, and industrial inspection. It features strong light illumination, long endurance, and high protection level.

KYB19-LED3x3- Handheld Searchlight

External Dimensions: 175*102mm

Rated Voltage: 3.7V

Capacity: 5.5Ah

Service Life: 100000h

Lighting Modes:

2 levels - Strong Light, Low Light (touch switch at lamp tail)

Battery Used: 3x 18650 Lithium Batteries

Discharge Time: High Light >5h; Low Light >8h

Weight: 0.8kg

Charging: DC

Light Source: Imported CREE



■ Technical Parameters

No.	ParameterName	Unit	Value
1	RatedVoltage	V	3.7
2	RatedCapacity	Ah	5.5
3	Rated Power	W	3.3
4	Continuous Discharge Time	HighLight	>5
		LowLight	>8
5	Dimensions	mm	175*102
6	Weight	Kg	0.8

► **Introduction**

The handheld searchlight is a high-performance mobile lighting tool specifically designed for high-risk operations, emergency rescue, and outdoor inspections. It features strong light long-range illumination, long endurance, multi-mode control, and high protection level. It is suitable for complex environments such as electric power inspections, flood control and disaster relief, petrochemical maintenance, and railway maintenance.

KYB20-LED3x3-Multi-functional Handheld Inspection Light ➤

External Dimensions: 215*88*144mm

Rated Voltage: 12V

Capacity: 4Ah

Service Life: 100000h

Lighting Modes:

2 levels - Strong Light, Working Light

Battery Used: 18650 Lithium Battery

Discharge Time: Strong Light >6h; Working Light >12h

Weight: 0.85kg

Charging: DC

Light Source: Imported CREE

Other Functions:

With magnetic attachment function, hand-crank power generation



■ **Technical Parameters**

No.	ParameterName	Unit	Value
1	RatedVoltage	V	12
2	RatedCapacity	Ah	4
3	Rated Power	W	3*3
4	Continuous Discharge Time	StrongLight	>6
		WorkingLight	>12
5	Dimensions	mm	215*88*144
6	Weight	Kg	0.85

► Introduction

The handheld explosion-proof searchlight is a high-safety mobile lighting device specifically designed for flammable and explosive places such as petroleum, chemical industry, coal mines, and firefighting. It has core features such as explosion-proof certification, high-brightness LED light source, long endurance, and IP65 or above protection level, and can work stably in extreme environments.

KYB21-LED3x3-Handheld Explosion-Proof Searchlight

External Dimensions: 123*235mm

Rated Voltage: 11.1V

Capacity: 4Ah

Service Life: 100000h

Lighting Modes:

2 levels - Strong Light, Working Light (touch switch)

Battery Used: 18650 Lithium Battery

Discharge Time: Strong Light >10h; Working Light >15h

Weight: 1.2kg

Charging: DC



■ Technical Parameters

No.	ParameterName	Unit	Value
1	RatedVoltage	V	11.1
2	RatedCapacity	Ah	4
3	Rated Power	W	3*3
4	Continuous Discharge Time	StrongLight	>10
		WorkingLight	>15
5	Dimensions	mm	123*235
6	Weight	Kg	1.2

► Introduction

The handheld explosion-proof searchlight is a high-safety mobile lighting device specifically designed for flammable and explosive places such as petroleum, chemical industry, coal mines, and firefighting. It has core features such as explosion-proof certification, high-brightness LED light source, long endurance, and IP65 or above protection level, and can work stably in extreme environments.

KYB22-LED3x3-Handheld Explosion-Proof Searchlight

External Dimensions: 197*70mm

Rated Voltage: 11.1V

Capacity: 4.4Ah

Service Life: 100000h

Lighting Modes:

2 levels - Low Light, Strong Light (touch switch)

Battery Used: 18650 Lithium Battery

Discharge Time: High Brightness >5h; Low Brightness >8h

Weight: 0.9kg

Charging: DC

Light Source: Imported CREE

Max. Range: 500 meters and above



■ Technical Parameters

No.	ParameterName	Unit	Value
1	RatedVoltage	V	11.1
2	RatedCapacity	Ah	4.4
3	Rated Power	W	3*3
4	Continuous Discharge Time	HighLight	>5
		LowLight	>8
5	Dimensions	mm	197*70
6	Weight	Kg	0.98

► **Introduction**

The handheld explosion-proof searchlight is a high-safety mobile lighting device specifically designed for flammable and explosive places such as petroleum, chemical industry, coal mines, and firefighting. It has core features such as explosion-proof certification, high-brightness LED light source, long endurance, and IP65 or above protection level, and can work stably in extreme environments.

KYB23-LED3x3-Handheld Explosion-Proof Searchlight ➤

External Dimensions: 197*70mm

Rated Voltage: 11.1V

Capacity: 4Ah

Service Life: 100000h

Lighting Modes:

3 levels - Working Light, Strong Light, Strobe (touch switch)

Battery Used: 18650 Lithium Battery

Discharge Time:

Strong Light >8h; Working Light >16h; Strobe >2 h

Weight: 0.8kg

Charging: DC

Light Source: Imported CREE



■ **Technical Parameters**

No.	ParameterName	Unit	Value
1	RatedVoltage	V	11.1
2	RatedCapacity	Ah	4
3	Rated Power	W	3*3
4	Continuous Discharge Time	StrongLight	>8
		WorkingLight	>16
		strobelight	>24
5	Dimensions	mm	163*68
6	Weight	Kg	0.8

► **Introduction**

The handheld explosion-proof searchlight is a high-safety mobile lighting device specifically designed for flammable and explosive places such as petroleum, chemical industry, coal mines, and firefighting. It has core features such as explosion-proof certification, high-brightness LED light source, long endurance, and IP65 or above protection level, and can work stably in extreme environments.

KYB24-LED12-Handheld Explosion-Proof Searchlight ➔

External Dimensions: 81*300mm

Rated Voltage: 22.2V

Capacity: 2.5Ah

Power: 12W

Service Life: 100000h

Lighting Modes: 2 levels - Strong Light, Low Light (tail switch)

Battery Used: 18650 Lithium Battery

Discharge Time: High Brightness >9h; Low Brightness >12h

Weight: 1.5kg

Charging: DC

Light Source: Imported CREE



■ **Technical Parameters**

No.	ParameterName	Unit	Value
1	RatedVoltage	V	22.2
2	RatedCapacity	Ah	2.5
3	Rated Power	W	12
4	Continuous Discharge Time	HighLight	>9
		LowLight	>12
5	Dimensions	mm	81*300
6	Weight	Kg	1.5

► **Introduction**

The handheld explosion-proof searchlight is a high-safety mobile lighting device specifically designed for flammable and explosive places such as petroleum, chemical industry, coal mines, and firefighting. It has core features such as explosion-proof certification, high-brightness LED light source, long endurance, and IP65 or above protection level, and can work stably in extreme environments.

KYB25-LED3- Handheld Strong Light Inspection Work Light ➡

External Dimensions: 194*74*115mm

Rated Voltage: 3.7V

Capacity: 4Ah

Power: 3W

Service Life: 100000h

Lighting Modes:

2 levels - Strong Light, Working Light (tail switch)

Discharge Time: Strong Brightness >10h; Working Light >20h

Weight: 0.5kg

Charging: DC

Light Source: Imported CREE



■ **Technical Parameters**

No.	ParameterName	Unit	Value
1	RatedVoltage	V	3.7
2	RatedCapacity	Ah	4
3	Rated Power	W	3
4	Continuous Discharge Time	HighLight	>10
		LowLight	>20
5	Dimensions	mm	194*74*115
6	Weight	Kg	0.5

► **Introduction**

The handheld explosion-proof strong light work light is a professional lighting tool designed for flammable, explosive, and high-risk working environments such as petroleum, chemical industry, metallurgy, and firefighting. It features explosion-proof certification, high-brightness LED light source, long endurance, high protection level, and multiple carrying methods, ensuring safe and reliable use under extreme conditions.

KYB26-LED5-Explosion-Proof Strong Light Work Light ➔

External Dimensions: 69*154mm

Rated Voltage: 3.7V

Capacity: 4Ah

Power: 5W

Service Life: 100000h

Lighting Modes:

2 levels - Strong Light, Working Light (touch switch)

Discharge Time:

High Brightness >4h; Low Brightness >8h

Weight: 0.5kg

Charging: DC

Light Source: Imported CREE



■ **Technical Parameters**

No.	ParameterName	Unit	Value
1	RatedVoltage	v	3.7
2	RatedCapacity	Ah	4
3	Rated Power	W	5
4	Continuous Discharge Time	HighLight	>4
		LowLight	>8
5	Dimensions	mm	69*154
6	Weight	Kg	0.5

► **Introduction**

The portable LED uniform light exploration lamp is a professional lighting tool designed for high-risk operations, emergency rescue, and detailed investigation scenarios. It features uniform light, multi-band switching, long endurance, and high protection level. It is widely used in fields such as electric power inspection, flood control and disaster relief, criminal investigation, and petrochemical industry.

KYB27-LED-Portable LED Uniform Light Exploration Lamp ➤

External Dimensions: 100*100*165mm

Rated Voltage: DC3.7V

Vehicle Rated Voltage: DC12-24V

Capacity: 4Ah

Sound and Light: ≥15h

Service Life: 100000h

Sound: ≥25h

Strobe: 35h

Weight: 530g

Charging Time: 8h

Protection Grade: IP65



■ **Technical Parameters**

No.	ParameterName	Unit	Value
1	RatedVoltage	v	DC3.7
2	RatedCapacity	Ah	4
3	VehicleRatedVoltage	v	DC12-24
4	LightSourceServiceLife	h	10000
5	Continuous Discharge Time	Sound and Light	≥15
		Sound	≥25
		Strobe	≥35
5	Dimensions	mm	100*100*165
6	Weight	g	530

► **Introduction**

The handheld rechargeable inspection work light is a portable lighting tool designed for high-risk or outdoor mobile operation scenarios such as electric power maintenance, flood control and disaster relief, petrochemical inspection, and railway train inspection. It features a high-brightness LED light source, long-endurance lithium battery, IP65 or above protection level, and multiple carrying methods. It can work stably without an external power source, ensuring operational safety at night or in low-light environments.

KYB28-LED3-Handheld Rechargeable Inspection Work Light ➤

External Dimensions: 220*85*116mm

Rated Voltage: 3.7V

Light Source: Imported CREE

Capacity: 4.4Ah

Battery Used: 18650 Lithium Battery

Service Life: 100000h

Lighting Modes:

Strong Light - Working Light - Low Light - Flashing

Discharge Time: Strong Light >12h, Working Light >25h

Weight: 0.8kg

Charging: Direct Charging

Other Functions: With magnetic attachment function, with hand-crank power generation



■ **Technical Parameters**

No.	ParameterName	Unit	Value
1	RatedVoltage	V	3.7
2	RatedCapacity	Ah	4.4
3	Rated Power	w	3
4	Continuous Discharge Time	HighLight	≥15
		LowLight	≥25
5	Dimensions	mm	220*85*116
6	Weight	kg	0.8

► **Introduction**

The Strong Light Field Emergency Work Light is a high-performance lighting tool specifically designed for high-risk operations and emergency rescue scenarios involving the military, public security, fire departments, electric power, railways, petroleum, and other sectors. It features high brightness, long battery life, multiple modeswitching, an IP65 or higher protection rating, and an impact-resistant structure. It operates stably in harsh environments such as heavy rain, dust, and high temperatures, meeting the needs of nighttime repairs, accident handling, and field search and rescue missions. It features built-in AC and DC charging methods, allowing it to be charged via a car cigarette lighter or standard mains electricity.

**KYB29-LED3-Strong Light Field
Emergency Work Light** ➔

Dimensions: 205 * 80 * 175mm

Rated Voltage: 3.7V

Light Source: Imported CREE

Capacity: 4.4 Ah

Lifespan: 100,000 hours

Lighting Modes: Strong light / Working light

Discharge Time: Strong light > 10h; Working light > 20h

Weight: 0.6kg

Charging: Direct charging

Other Functions: With magnetic attachment function, with hand-crank power generation



■ **Technical Parameters**

No.	ParameterName	Unit	Value
1	RatedVoltage	V	3.7
2	RatedCapacity	Ah	4.4
3	Rated Power	w	3
4	Continuous Discharge Time	High Light	> 15
		Low Light	> 20
5	Dimensions	mm	205*80*175
6	Weight	kg	0.6

► Introduction

The vehicle-mounted remote control searchlight is a highly reliable lighting device specifically designed for mobile vehicles such as engineering vehicles, emergency rescue vehicles, patrol cars, and ships. It features long-distance illumination, multi-angle remote control adjustment, and strong environmental adaptability. It is widely used in complex operation scenarios such as electric power line patrol, lake and sea search and rescue, scene investigation, and fire rescue.

KYB30-LED35-Vehicle-Mounted Remote Control Searchlight ➤

External Dimensions: 310*265*355mm

Rated Voltage: 12-24V

Light Source: HID

Service Life: 100000h

Lighting Mode: Remote Control

Weight: 470g

Other Functions:

With magnetic attachment function



► Introduction

The vehicle-mounted remote control searchlight is a highly reliable lighting device specifically designed for mobile vehicles such as engineering vehicles, emergency rescue vehicles, patrol cars, and ships. It features long-distance illumination, multi-angle remote control adjustment, and strong environmental adaptability. It is widely used in complex operation scenarios such as electric power line patrol, lake and sea search and rescue, scene investigation, and fire rescue.

KYB31-LED30-Vehicle-Mounted Remote Control Searchlight ➤

External Dimensions: 310*265*355mm

Rated Voltage: 12-24V

Light Source: Imported CREE

Service Life: 100000h

Lighting Mode: Remote Control

Weight: 470g

Other Functions:

With magnetic attachment function



► **Introduction**

The multi-functional magnetic strong light work light is a portable lighting tool designed for high-risk or complex working environments such as auto repair, outdoor emergency, and electric power inspection. It features core advantages such as strong light long-range illumination, magnetic fixation, multi-mode adjustment, and long endurance. It is widely used in maintenance and emergency repair, night operations, and field rescue scenarios.

KYB32-LED2x3-Multi-functional Magnetic Strong Light Work Light ➤

External Dimensions: 220*105*86mm

Rated Voltage: 3.7V

Light Source: Imported CREE

Capacity: 4.4Ah

Service Life: 100000h

Lighting Mode: Central Electronic Switch

Discharge Time: Strong Light >8h; Working Light >14h

Weight: 400g

Charging: Direct Charging

Other Functions: With magnetic attachment function

Protection Rating: IP68



■ **Technical Parameters**

No.	ParameterName	Unit	Value
1	RatedVoltage	V	3.7
2	RatedCapacity	Ah	4.4
3	Rated Power	w	2*3
4	Continuous Discharge Time	StrongLight	>8
		WorkingLight	> 14
5	Dimensions	mm	220*105*86
6	Weight	g	400

► **Introduction**

Equipped with flashlight function, signal light function, three adjustable daylight lamp functions, high-brightness light warning flashing function, single-button control switch and one-key quick on/off function. It has a DC5V, 1A USB output interface, which can provide emergency charging for digital products at any time.

KYB33-LED3/6-Explosion-Proof Maintenance Work Light ➤

External Dimensions: 240*47mm

Rated Voltage: 3.7V

Light Source: Imported CREE

Capacity: 5Ah

Service Life: 100000h

Lighting Modes: Working Light - Strong Light

Discharge Time:

Strong Light >4h, Working Light >8h

Weight: 0.53kg

Other Functions: With magnetic attachment function



■ **Technical Parameters**

No.	ParameterName	Unit	Value
1	RatedVoltage	V	3.7
2	RatedCapacity	Ah	5
3	Rated Power	w	3/6
4	Continuous Discharge Time	StrongLight	>4
		WorkingLight	>8
5	Dimensions	mm	240*47
6	Weight	kg	0.53

► **Introduction**

USB uses a high-energy maintenance-free battery with charge/discharge and short circuit protection, safe and reliable. Built-in laser pointing function (optional), warning specification 10kV, warning distance >0.7m. When personnel approach high voltage, it warns through color flashing.

KYB34-LED2-Explosion-Proof Maintenance Work Light ➤

External Dimensions: Φ35*180mm

Rated Voltage: 3.7V

Protection Rating: IP66

Lighting Power (Strong Light): 2W

Capacity: 2.5Ah

Service Life: 100000h

Light Source Color Temperature: 5000-7000K

Continuous Discharge Time:

Strong Light ≥4h; Working Light ≥8h



■ **Technical Parameters**

No.	ParameterName	Unit	Value
1	RatedVoltage	V	3.7
2	RatedCapacity	Ah	2.5
3	Rated Power	w	2
4	Continuous Discharge Time	StrongLight	≥4
		WorkingLight	≥8
5	Dimensions	mm	Φ35*180

► Introduction

The multi-functional magnetic strong light explosion-proof work light is a professional lighting tool designed for high-risk working environments with flammable and explosive risks such as petroleum, chemical, electric power, metallurgy, railway, and firefighting. It features explosion-proof certification, strong light long-range illumination, multi-mode adjustment, magnetic adsorption, and industrial-grade protection. It can be safely used in Zone 1 and Zone 2 explosive gas environments, ensuring the lighting needs and personnel safety for operations such as night inspections, equipment maintenance, and emergency repairs.

KYB34-LED3-Multi-functional Strong Light Explosion-Proof Work Light ➤

External Dimensions: 225*50mm

Rated Power: 3W / 300lm (optional 5W / 500lm)

Levels: Three levels (Working Light - Strong Light - Strobe)

Rated Voltage: DC3.7V

Capacity: 2.6Ah (built-in)

Charging Time: 4-5h

Continuous Discharge Time: Working Light ≥ 16 h; Strong Light ≥ 8 h

Protection Rating: IP66

Product Weight: Single unit 290g, Full set 470g



■ Technical Parameters

No.	ParameterName	Unit	Value
1	RatedVoltage	V	3.7
2	RatedCapacity	Ah	2.6
3	Rated Power	w/lm	3w/300lm
4	Continuous Discharge Time	StrongLight	≥ 8
		WorkingLight	≥ 16
5	Dimensions	mm	225*50

► **Introduction**

The solid-state maintenance-free strong light flashlight is an industrial-grade lighting tool specially designed for high-risk and harsh environments. It is widely used in inspection, emergency repair, and emergency scenarios in industries such as railway, electric power, firefighting, oilfields, metallurgy, and petrochemicals. Its core advantages lie in the use of LED solid-state light source, maintenance-free design, long endurance, and high protection level, enabling it to continuously provide stable and reliable lighting support without the need for bulb replacement and frequent maintenance.

KYB35-LED3-Solid-State Maintenance-Free Strong Light Flashlight ➤

External Dimensions: 60*180mm

Rated Power: 3W

Rated Voltage: 3.7V

Capacity: 4Ah

Lighting Modes: 2 levels - Low Light, Strong Light

Continuous Discharge Time:

Main Light >12h; Tail Light >24h

Max. Range: 500m

Weight: 500g



■ **Technical Parameters**

No.	ParameterName	Unit	Value
1	RatedVoltage	V	3.7
2	RatedCapacity	Ah	4
3	Rated Power	w	3
4	Discharge Time	Main Light	> 12
		Tail Light	> 24
5	Dimensions	mm	60*180

► **Introduction**

The micro multi-functional signal light is a portable industrial lamp integrating signal indication, safety warning, and mobile lighting. It is widely used in high-risk or night operation scenarios such as railways, electric power, public security, firefighting, oil fields, and industrial mines. It achieves long-distance communication and warning through multi-color signal light sources such as red, yellow, and green, while being equipped with white strong light illumination function to meet the needs of composite tasks such as inspections and emergency repairs. It features high protection level, long endurance, and magnetic attachment design, making it an ideal tool adaptable to multiple scenarios like vehicle mounting, handheld, and belt hanging.

KYB36-LED3-Micro Multi-functional Signal Light ➤

External Dimensions: 60*180mm

Rated Power: 3W

Rated Voltage: 3.7V

Capacity: 4Ah

Service Life: 100000h

Lighting Modes:

2 levels - Low Light, Strong Light, Signal

Continuous Discharge Time:

Main Light ≥16h; Tail Light ≥20h

Weight: 500g



► **Introduction**

The micro multi-functional signal light is a portable industrial lamp integrating signal indication, safety warning, and mobile lighting. It is widely used in high-risk or night operation scenarios such as railways, electric power, public security, firefighting, oil fields, and industrial mines. It achieves long-distance communication and warning through multi-color signal light sources such as red, yellow, and green, while being equipped with white strong light illumination function to meet the needs of composite tasks such as inspections and emergency repairs. It features high protection level, long endurance, and magnetic attachment design, making it an ideal tool adaptable to multiple scenarios like vehicle mounting, handheld, and belt hanging.

KYB37-LED3-Micro Multi-functional Signal Light ➤

External Dimensions: 60*180mm

Rated Power: 3W

Rated Voltage: 3.7V

Capacity: 4Ah

Battery Used: Lithium Battery

Service Life: 100000h

Lighting Modes: 2 levels - Low Light, Strong Light, Signal

Continuous Discharge Time: Main Light ≥16h; Tail Light ≥20h

Weight: 500g



► Introduction

The multi-functional signal light is a portable industrial lamp integrating multi-color signal indication, strong light illumination, and safety warning. It is specially designed for high-risk or night operation environments such as railways, electric power, public security, firefighting, petrochemicals, and industrial mines. It can achieve long-distance dispatching communication and area warning through colors such as red, yellow, and green, and also has white strong light illumination function to meet the needs of various tasks such as inspections, emergency repairs, and emergencies. It is key equipment for improving operational safety and coordination efficiency.

KYB38-LED3-Multi-functional Strong Light Patrol Flashlight ➤

External Dimensions: 170*38*29mm

Rated Power: 3W

Rated Voltage: 3.7V

Capacity: 2.2Ah

Service Life: 100000h

Lighting Mode: Central electronic switch,

3 levels - Working Light, Strong Light, Strobe

Discharge Time: High Brightness >8h,

Low Brightness >20h

Charging: Direct Charging

Weight: 82g (excluding battery)



► Introduction

The double-sided orientation light is a composite warning and lighting tool designed for high-risk working environments. It is widely used in scenarios such as railways, electric power, municipal construction, traffic management, and emergency rescue. It combines multi-color signal indication, two-way visual warning, and strong light illumination functions, supporting various usage methods such as magnetic attachment, handheld, and hook hanging. It can achieve integrated operation of long-distance communication, orientation marking, and task lighting in low visibility or complex environments.

KYB39-Double-Sided Orientation Light ➤

External Dimensions: 100*350*268mm

Rated Voltage: 3.6V

Capacity: 1.8Ah

Battery Used: 18650 Lithium Battery

Service Life: 100000h

Lighting Modes: Constant On - Strobe

Continuous Discharge Time: Main Light ≥6h; Flash ≥1.5±0.5Hz

Charging: Direct Charging

Other Functions: With magnetic attachment function

Weight: 0.64kg



► Introduction

The multi-functional audible and visual alarm is an industrial safety device integrating sound and light warning functions. It is widely used in high-risk operation scenarios such as railways, electric power, chemical industry, transportation, and firefighting. It issues immediate warnings to personnel through high-decibel sound and strong light flashes in case of sudden failures, dangerous leaks, or emergencies, improving on-site response efficiency and safety management capabilities

KYB40-LED10-Multi-functional Audible and Visual Alarm

External Dimensions: $\Phi 64 \times 250$ mm

Rated Power (LED): 10W

Light Distribution Uniformity: 0.9

Current: 2800mA (Search Light) / 1200mA (Photo Light)

Continuous Discharge Time: 4h (Search Light) / 10h (Photo Light)

Luminous Flux: 650lm (Search Light) / 350lm (Photo Light)

Charging Time: 6h

Enclosure Protection Grade: IP65

Weight: 1.1kg

Battery Service Life: approx. 1000 (cycles)



► Introduction

Added - Features hand-wave sensing function, lighting can be turned off/on by waving hand within 20cm. - Live line proximity warning function: When the device's live line proximity alarm function is turned on, the device emits an alarm sound when the lamp head approaches high voltage, and the alarm is only canceled when away from the high voltage source.

KYB41- Micro Explosion-Proof Headlamp

External Dimensions: 78*48*43mm

Rated Voltage: 3.7V

Capacity: 2Ah

Light Source LED:

Color Temperature:

Cool White 5300-7000K; Warm White 2700-3500K

Average Service Life: 50000h

Continuous Discharge Time:

Strong Light >8h; Super Strong Light >4h; Working Light >16h

Weight: 96g



► Introduction

The micro explosion-proof headlamp is a lightweight lighting tool designed for flammable and explosive places such as railways, electric power, oil fields, chemical industry, and firefighting. It is suitable for high-risk operation scenarios like night inspections, equipment maintenance, and emergency rescue. Its core advantages lie in the intrinsic safety explosion-proof design and high-reliability lighting performance, ensuring stable operation without causing danger in explosive gas or dust environments.

KYB42-LED3-Micro Explosion-Proof Headlamp ➡

External Dimensions: 80*63*57mm

Light Source: Imported CREE

Power: 3W

Voltage: 3.7V

Capacity: 1.8Ah

Battery Used: Polymer Lithium Battery

Service Life: 100000h

Lighting Modes: 2 levels - Strong Light, Low Light

Discharge Time: Strong Light >4h, Working Light >8h

Charging: Direct Charging

Weight: 150g



► Introduction

The explosion-proof dimmable work light is a portable lighting tool designed for flammable, explosive, or high-risk working environments such as railways, electric power, petrochemicals, metallurgy, and mines. It features intrinsic safety explosion-proof performance, multi-level dimming function, and high protection level. It can be safely used in Zone 1 and Zone 2 explosive gas environments, meeting the precise lighting needs under various complex working conditions such as inspections, emergency repairs, and emergencies.

KYB43-LED1- Explosion-Proof Dimmable Work Light ➡

External Dimensions: 66*51*50mm

Rated Voltage: 3.7V

Capacity: 1.6Ah

Battery Used: Polymer Lithium Battery

Lighting Modes: 2 levels - Strong Light, Working Light

Discharge Time: Strong Light >5h, Working Light >10h

Charging: Direct Charging

Weight: 88g



► Introduction

The micro explosion-proof headlamp is a lightweight lighting tool designed for flammable and explosive places such as railways, electric power, oil fields, chemical industry, and firefighting. It is suitable for high-risk operation scenarios like night inspections, equipment maintenance, and emergency rescue. Its core advantages lie in the intrinsic safety explosion-proof design and high-reliability lighting performance, ensuring stable operation without causing danger in explosive gas or dust environments.

KYB44-LED3-Micro Explosion -Proof Headlamp ➤

External Dimensions: 80*65*52mm

Light Source: Imported CREE

Power: 3W

Voltage: 3.7V

Capacity: 1.8Ah

Battery Used: Polymer Lithium Battery

Service Life: 100000h

Lighting Modes: 2 levels - Strong Light,
Low Light (touch switch)

Discharge Time: High Light >5h, Low Brightness >10h

Charging: Direct Charging

Weight: 100g



► Introduction

The micro explosion-proof headlamp is a lightweight lighting tool designed for flammable and explosive places such as railways, electric power, oil fields, chemical industry, and firefighting. It is suitable for high-risk operation scenarios like night inspections, equipment maintenance, and emergency rescue. Its core advantages lie in the intrinsic safety explosion-proof design and high-reliability lighting performance, ensuring stable operation without causing danger in explosive gas or dust environments.

KYB45-LED3-Micro Explosion -Proof Headlamp ➤

External Dimensions: 80*65*52mm

Light Source: Imported CREE

Power: 3W

Rated Voltage: 3.7V

Capacity: 1.8Ah

Battery Used: Polymer Lithium Battery

Lighting Modes: 2 levels - Strong Light, Low Light

Discharge Time: Strong Light >5h, Working Light >10h

Charging: Direct Charging

Weight: 100g



► Introduction

Product Introduction/Introduction The energy-saving strong light explosion-proof flashlight is a special lighting tool designed for high-risk working environments. It is widely used in flammable and explosive places such as petroleum, chemical industry, firefighting, electric power, and mines. It has core properties such as explosion-proof, waterproof, impact-resistant, and long endurance. It uses a high-efficiency LED light source and intrinsically safe circuit design, which can provide stable long-distance, high-brightness illumination while eliminating the risk of explosion caused by electric sparks.

KYB46-LED3-Energy-Saving Strong Light Explosion-Proof Flashlight ➤

External Dimensions: 40*215mm

Power: 3W

Voltage: 3.7V

Capacity: 4.4Ah

Service Life: 80000h

Battery Used: 18650 Lithium Battery

Lighting Modes: 2 levels - Medium Light,

Strong Light (long press for police strobe)

Discharge times: High Brightness >7h; Low Brightness >22h

Charging: DC, central electronic switch

Weight: 360g (including battery)



► Introduction

The micro explosion-proof headlamp is a lightweight lighting tool designed for flammable and explosive places such as railways, electric power, oil fields, chemical industry, and firefighting. It is suitable for high-risk operation scenarios like night inspections, equipment maintenance, and emergency rescue. Its core advantages lie in the intrinsic safety explosion-proof design and high-reliability lighting performance, ensuring stable operation without causing danger in explosive gas or dust environments.

KYB48-LED3-Micro Explosion-Proof Headlamp ➤

External Dimensions: 35*78*70mm

Power: 3W

Voltage: 3.7V

Capacity: 1.6Ah

Service Life: 100000h

Discharge Time: Strong Light ≥7h;

Working Light ≥14h

Charging Time: ≥6H

Weight: ≥0.12kg

Protection Rating: IP65



► Introduction

12000000 high-definition camera, 1080P high-definition resolution, clearly records every moment of work; WiFi smart monitoring, real-time image transmission and sharing via mobile phone or tablet; GPS positioning function, records the entire work track; user-friendly 2.0-inch large screen design for more convenient human-machine interaction; spotlight and floodlight illumination can be switched arbitrarily.

KYB47-Multi-functional Camera Light

External Dimensions: 95*64*55mm

Light Source: Spotlight Illuminance 500lux;

Floodlight Illuminance 3lux

Color Temperature: 6000-7000K

Battery Life: 1000 (cycles)

Capacity: 2.6Ah

Continuous Video Recording Time: ≥4h

Charging Time (full discharge): 4h

Weight: 160g

Storage Capacity: 64G



► Introduction

The micro explosion-proof flashlight is a portable lighting tool designed for flammable, explosive, high-risk environments. It is widely used in places such as firefighting, petrochemicals, electric power, metallurgy, mines, and ships, ensuring safe use in environments with combustible gases, dust, or vapors. Its core lies in eliminating the risk of explosion caused by electric sparks through explosion-proof structural design, while providing stable strong light illumination.

KYB50-Micro Explosion-Proof Flashlight

External Dimensions: $\Phi 23.2 \times 115.2$ mm

Power: 3W

Light Source: Luminous Flux: Working Light 110lm; Strong Light 233lm

Rated Voltage: 3.7V

Rated Capacity: 1900mAh

Service Life: 100000h

Continuous Discharge Time: Working Light ≥8h;

Strong Light ≥8h

Lighting Modes: 2 levels - Medium Light,

Strong Light (long press for police strobe)

Charging Time: (when fully discharged) <4h

Battery Service Life: 1000 (cycles)

Weight: 85 ± 2 g



► Introduction

The micro explosion-proof flashlight is a portable lighting tool designed for flammable, explosive, high-risk environments. It is widely used in places such as firefighting, petrochemicals, electric power, metallurgy, mines, and ships, ensuring safe use in environments with combustible gases, dust, or vapors. Its core lies in eliminating the risk of explosion caused by electric sparks through explosion-proof structural design, while providing stable strong light illumination.

KYB51-LED3-Micro Explosion -Proof Flashlight ➤

External Dimensions: 23*117mm

Power: 3W

Light Source: Imported CREE

Voltage: 3.7V

Capacity: 2.2Ah

Service Life: 80000h

Battery Used: 18650 Lithium Battery

Lighting Modes: 2 levels - Strong Light, Low Light, long press for strobe, tail switch

Discharge times: High Brightness >4h; Low Brightness >8h

Charging: Micro-USB Direct Charging

Other Functions: 4-level battery level display function

Weight: 100g



► Introduction

The micro explosion-proof flashlight is a portable lighting tool designed for flammable, explosive, high-risk environments. It is widely used in places such as firefighting, petrochemicals, electric power, metallurgy, mines, and ships, ensuring safe use in environments with combustible gases, dust, or vapors. Its core lies in eliminating the risk of explosion caused by electric sparks through explosion-proof structural design, while providing stable strong light illumination.

KYB52-LED3-Micro Explosion -Proof Flashlight ➤

External Dimensions: 275*130*140mm

Power: 3W

Light Source: Imported CREE

Voltage: 3.7V

Capacity: 2.2Ah

Service Life: 80000h

Lighting Modes: 2 levels - Low Light, Strong Light (touch switch)

Other Functions: Tail with magnetic attachment function; panel LCD battery level display

Discharge Time: High Brightness >7h, Low Brightness >12h

Charging: Direct Charging

Weight: 1380g



► Introduction

The micro explosion-proof flashlight is a portable lighting tool designed for flammable, explosive, high-risk environments. It is widely used in places such as firefighting, petrochemicals, electric power, metallurgy, mines, and ships, ensuring safe use in environments with combustible gases, dust, or vapors. Its core lies in eliminating the risk of explosion caused by electric sparks through explosion-proof structural design, while providing stable strong light illumination.

KYB53-Micro Explosion-Proof Flashlight ➤

External Dimensions: 32*145mm

Light Source: Imported CREE

Voltage: 3.7V

Capacity: 2.2Ah

Service Life: 100000h

Battery Used: 18650 Lithium Battery

Lighting Modes: Low Light - High Light - Off;

long press 3s for strobe

Discharge times : High Brightness >8h;

Low Brightness >16h

Charging: Direct Charging

Weight: 150g



► Introduction

The multi-functional strong light patrol explosion-proof flashlight is a professional lighting tool designed for high-risk industrial environments. It is widely used in places with flammable and explosive risks such as petrochemicals, electric power, firefighting, mines, and metallurgy. This type of equipment not only has super brightness and long range, but also ensures through explosion-proof certification that accidents caused by electric sparks will not occur in dangerous environments. At the same time, it integrates multiple practical functions to meet the needs of complex tasks such as patrol, emergency, and rescue.

KYB54-LED3-Multi-functional Strong Light Patrol Explosion-Proof Flashlight ➤

External Dimensions: 275*130*140mm

Power: 3W

Light Source: Imported CREE

Voltage: 3.7V

Capacity: 2.2Ah

Service Life: 100000h

Lighting Mode: Central electronic switch

Working Light - Strong Light - long press for police strobe sound

Discharge Time: Strong Light >5h; Low Light >10h

Charging: DC

Weight: 150g



► Introduction

The multi-functional strong light patrol explosion-proof flashlight is a professional lighting tool designed for high-risk working environments such as petroleum, chemical, electric power, and firefighting. It has core properties such as explosion-proof, waterproof, impact-resistant, and long endurance, ensuring safe use in flammable and explosive places while providing stable and efficient mobile emergency lighting.

KYB55-LED3-Multi-functional Strong Light Patrol Explosion-Proof Flashlight ➤

External Dimensions: 28*128mm

Light Source: Imported CREE

Voltage: 3.7V

Capacity: 2.2Ah

Service Life: 100000h

Battery Used: 18650 Lithium Battery

Lighting Mode: On/Off

White Light Mode: Low Light - High Light - Off;

long press 3s for strobe

Discharge Time: High Brightness >8h;

Low Brightness >16h

Charging: DC

Weight: 150g



► Introduction

The multi-functional lightweight camera lighting flashlight is an integrated device designed for professional scenarios such as industrial inspections, emergency rescue, and law enforcement recording. It integrates functions such as lighting, video recording, photo taking, audio recording, and positioning. While ensuring high-brightness illumination, it achieves full-process video recording of the operation. It combines the special requirements of the petroleum/chemical industry for explosion-proof, waterproof, lightweight, and portability.

KYB56-LED1-Multi-functional Lightweight Camera Lighting Flashlight ➤

External Dimensions: 175*45*35 mm

LED Power: 1W

Weight: ≤235g

Display Screen: 1.3-inch HD LCD screen

Video Format: MP4

Train Warning: ≥3km (optional function in open areas)

Signal Light: Red, Green signal lights (optional function)

UV Light: Metal surface detection (optional function)

Working Time: Recording + Lighting operation ≥6h

Working Voltage: 3.7V

Battery: 10000mAh rechargeable battery

Storage Capacity: Standard 16GB (Max. support 256GB)



► Introduction

Product Introduction/Introduction The multi-functional strong light patrol explosion-proof flashlight is a professional lighting tool designed for high-risk working environments such as petroleum, chemical, electric power, and firefighting. It has core properties such as explosion-proof, waterproof, impact-resistant, and long endurance, ensuring safe use in flammable and explosive places while providing stable and efficient mobile emergency lighting.

KYB57-LED7-Portable Strong Light Lighting Set

Dimensions: 245*85*145mm

Battery Rated Voltage: 12V

Battery Rated Capacity: 5Ah

Power: 30/7/3W

Discharge Time: Super Strong Light \geq 5h;

Strong Light \geq 10h; Working Light \geq 36h

Average Service Life: 100000h

Type-C Fast Charging: \leq 4.5h

Magnetic Charging: \leq 8h

USB Output Interface: DC5V 2A

Explosion-proof Mark: Ex d ib IIC T4 Gb

Protection Rating: IP66/IP68



► Introduction

A mobile lighting system integrating high brightness and portability is typically used in scenarios requiring rapid deployment of strong lighting, such as field operations, emergency rescue, fire fighting, and law enforcement. The entire system generally includes multiple independently usable high-intensity lamp heads, a portable tripod, a lithium battery pack, and a storage case. It supports multi-angle lighting and continuous operation for extended periods, and features waterproof, shockproof, and easy-to-carry characteristics, meeting comprehensive lighting needs in complex environments.

KYB59-LED35-Portable Strong Light Lighting Set

Dimensions: 245*85*151±5mm

Rated Voltage: 11.1v

Rated Battery Capacity: 5Ah

Rated Power: 36w

Charging Method: Type-C fast charging and docking station charging

Battery Charging Time:

Fast charging: 12V, 6h; Standard charging: 5V, 8h

Continuous Discharge Time: Super bright: 30W/5h; High brightness: 7W/10h

Weight: 1.5kg

Positioning Function: Built-in positioning chip



Emergency Lighting Lamps

► Introduction

Suitable for providing on-site floodlighting and long-distance searchlighting during traffic accident scene handling by traffic police, and during search, investigation, inspection by criminal police, special police, anti-drug police, etc. It can also be used for loudspeaker warning or megaphone command during interception and pursuit, as well as for positioning, warning, and emergency use at various work sites. Suitable for multi-functional applications such as floodlighting,

Integrated design: Lightweight and efficient, the lamp and case are integrated, no need to install or remove the lamp head.

YJB2-LED2x55-LED Lightweight Area Work Light

- Dimensions (stored state): 635*350*210mm
- Dimensions (Maximum rise highest): 635*350*1860mm
- Megaphone (Speaker) Power: 30W
- Charging Time: ≤8h
- Battery Capacity: 34Ah
- Wireless Bluetooth Connection Distance: 30m
- Dimming Type: Stepless dimming 10% - 100%
- Protection Rating: Lamp Head IP66 / Case IP65



■ Technical Parameters

No.	ParameterName	Unit	Value	
1	RatedVoltage	V	DC21.6v	
2	BatteryRated Capacity	Ah	34	
3	LightSourceLED	Ratedpower	W	2*55
		Service life	H	100000
		Dim mode	%	10%-100%
4	Dimmode	/	Adjustable spotlight/floodlight	
5	Warninglight color	/	Red/Blue	
6	Lightingtime	聚泛光	H	8
		聚光	H	16
		泛光	H	14
7	Battery life	cycles	1000	
8	Chargingtime	H	≤8	
9	Dimensions	Storagestate	mm	635*350*210
		Maximumrise highest	mm	635*350*1860
10	Weight	Kg	20±1	

► Introduction

In the dead of night while camping, at emergency repair scenes, or in temporary supplementary lighting scenarios for large events, an easy-to-use mobile lighting device is key to efficiently meeting demands. This handheld/backpack dual-purpose lamp, with its humanized design and powerful performance, becomes an ideal choice for multi-scenario lighting.

Dual-mode portable design: Adapts to multiple scenarios, breaking the single-carry limitation of traditional lighting devices.

High-brightness LED light source, lasting illumination in the dark: easily lights up a super large area.

YJB3-LED60- LED Lightweight Area Work Light

Dimensions (Storage state):

500×310×200±20mm

Dimensions (Maximum rise highest):

635×350×1860±30mm

Rated LED power: 60W

Color temperature: 5000–6000K

Operating temperature range: -20°C to 40°C

Protection rating: Lamp head IP65 / Housing IP54



■ Technical Parameters

No.	Parameter Name	Unit	Value
1	Rated Voltage	v	DC22.2v
2	Battery Rated Capacity	Ah	18
3	Light Source (LED)	W	60
4	Lighting Type (Continuous Lighting)	H	>7
5	Warning Light Color	/	Red/Yellow/Blue batteries
6	Charger Input Voltage	v	AC220V
7	Battery Service Life	cycles	>500
8	Charging Time	H	<8
9	Dimensions	Storage state	500*350*210
		Maximum rise highest	635*350*1860
10	Weight	Kg	20±1

► Introduction

Provides mobile lighting for high-brightness large-area night lighting and other work sites during on-site operations, accident emergency repairs, abnormal situation handling in various flammable and explosive places for units such as railways, electric power, public security, military, ships, and petrochemicals.

Dual-mode portable design: Adapts to multiple scenarios, breaking the single-carry limitation of traditional lighting devices.

Lamp head and lighting adjustment: Double-sided high-efficiency LED lamp heads provide high-brightness, large-area lighting with long life.

YJB4-LED2x30 Multi-functional Mobile Lighting System

Dimensions (stored state): 365*330*620mm

Dimensions (max. raised): 365*330*1800mm

Lighting Type: Spotlight / Floodlight

Charging Time: ≤6h

Protection Rating: Lamp Head IP65, Case IP54



■ Technical Parameters

No.	Parameter Name	Unit	Value	
1	Rated Voltage	V	DC25.2v	
2	Battery Rated Capacity	Ah	22	
3	Light Source (LED)	Rated Power	W	2*30
		Average Life	H	100000
4	Illuminance	Center Illuminance at 50m	lx	>3
		Center Illuminance at 5m	lx	>200
5	Lighting Angle	Horizontal Direction	Angle	≥180
		Vertical Direction	Angle	≥180
6	Lighting Type	/	spotlight/floodlight	
7	Continuous Lighting Time	h	≥8	
8	Charger Input Voltage	v	Ac220	
9	Connected Camera Pixels	万	800	
10	Video/Photo Format	/	MP4/JPEG	
11	Camera Storage Capacity	G	64	
12	Warning Light Color	/	Red/Yellow	
13	Megaphone (Speaker) Power	w	20-30	
14	Battery Service Life	cycles	appointmen500	
15	Charging Time	h	≤6	
16	Dimensions L*W*H	Storage state	mm	365*330*620
		Maximum rise highest	mm	365*330*1800
17	Weight	Kg	16.5	
18	Operating Environment	°C	-20~40	
19	Protection Rating	/	IP65 (for the lamp head) and IP54 (for the enclosure)	

► Introduction

Provides mobile lighting for high-brightness large-area night lighting and other work sites during on-site operations, accident emergency repairs, abnormal situation handling in various flammable and explosive places for units such as railways, electric power, public security, military, ships, and petrochemicals.

Carrying and deployment methods: Supports three portable modes: towing, handheld, and backpack, adapting to different terrains and operational needs.

YJB8-WJ45 Multi-functional Mobile Lighting System

Dimensions (stored state): 365*330*620mm

Dimensions (max. raised): 365*330*1800mm

Lighting Type: Spotlight / Floodlight

Charging Time: ≤6h

Protection Rating: Lamp Head IP65, Case IP54



■ Technical Parameters

No.	Parameter Name		Unit	Value
1	Rated Voltage		V	12
2	Battery Rated Capacity		Ah	24
3	Floodlight Head	Average Life	h	10000
		Rated Power	w	45
		Luminous Flux	lm	5500
4	Spotlight Head	Average Life	h	100000
		Rated Power	w	25
		Luminous Flux	lm	3000
5	Warning Light Color	Flashing Frequency	Hz	4
6	Battery Continuous Discharge Time		h	≥3.5 (all lights)
				≥10.5 (spotlight)
				≥7.5 (Floodlight)
7	Charging Time		h	≤16
8	Case Dimensions L*W*H	In Use (Lamp Head Extended)	mm	465*290*1900
		In Use (Platform Extended)		465*290*1500
		In Use (Contracted)		465*290*900
		Not in Use (Case)		465*290*575
9	Weight		Kg	25
10	Protection Rating		/	IP65 (for the lamp head) and IP54 (for the enclosure)

► Introduction

Applied to work sites requiring large-area high-intensity lighting such as field training, construction operations, emergency repair, flood control, medical rescue, film and television shooting, accident handling. Industry scope: Electric power, railway, military, police, firefighting, industry, exploration, construction, safety rescue, etc.

Case-type quick-release structure: Adopts a new case-type structural design, allowing simple and quick disassembly, assembly, and storage of the lamp.

YJB9-LED2x27- Portable Mobile Lighting System

External Dimensions: 600*415*230mm

Rated Voltage: 12V

Rated Capacity: 24Ah

Weight: 22Kg

Light Source: Round: 2*27W

Strong Light: 5500lm

Working Light: 2200lm



■ Technical Parameters

No.	ParameterName	Unit	Value
1	BatteryRatedVoltage	V	12
2	BatteryRatedCapacity	Ah	24
3	Current	StrongLight	1.0
		WorkingLight	0.7
4	circularlightsource	W	2*27
5	LuminousFlux	StrongLight	5500lm
		WorkingLight	2200lm
6	AverageServiceLife	h	100000
7	Continuous Discharge Time	StrongLight	8
		WorkingLight	18
		LowLight	30
8	ChargingTime	h	<10
9	BatteryServiceLife	cycles	approximately 1000
10	Dimensions	mm	600*415*230
11	Weight	Kg	22

► Introduction

Applied to work sites requiring large-area high-brightness lighting such as field training, construction operations, emergency repair, flood control, medical rescue, film and television shooting, accident handling. Industry scope: Electric power, railway, military, police, firefighting, industry, exploration, construction, safety rescue, etc.

Case-type quick-release structure: Adopts a new case-type structural design, allowing simple and quick disassembly, assembly, and storage of the lamp.

YJB10-LED4x36- Portable Mobile Lighting System

External Dimensions: 600*450*290mm

Rated Voltage: 12V

Rated Capacity: 24Ah

Weight: 28Kg

Light Source: Square: 4*36W

Strong Light: 11500lm

Working Light: 5400lm



■ Technical Parameters

No.	ParameterName	Unit	Value
1	RatedVoltage	V	12
2	RatedCapacity	Ah	24
3	Current	StrongLight	1.7
		WorkingLight	1.1
4	squarelightsource	W	4*36
5	LuminousFlux	StrongLight	11500lm
		WorkingLight	5400lm
6	AverageServiceLife	h	100000
7	Continuous Discharge Time	StrongLight	6
		WorkingLight	12
		LowLight	20
8	ChargingTime	h	<10
9	BatteryServiceLife	cycles	approximately 1000
10	Dimensions	mm	600*450*290
11	Weight	Kg	28

► Introduction

Provides mobile lighting for railways, electric power, public security, accident emergency repair, abnormal situation handling, outdoor mobile night emergency lighting, and other worksites.

Dual vehicle model adaptation: Tool-free three-part split for transport.

Dual 150W high-efficiency LEDs: long life, large coverage.

Mast red/blue warning light: multi-mode 4H2 flashing.

Electric push rod lifting: dual height + wide angle lighting.

All-metal durable structure: IP65 protection + Level 5 wind resistance.

YJB13-LED2x150- Omnidirectional Mobile Lighting Lamp

External Dimensions: 300*251*880mm

Rated Voltage: 14.8V

Rated Capacity: 10Ah

Working Voltage: 12V

Rated Power: 27W

When Battery Depleted: 10h

Luminous Flux: 3800lm

Weight: 8Kg



■ Technical Parameters

Rated Voltage	AC220V/50Hz	
IP Rating	IP66 (luminaire) / IP54 (luminaire enclosure)	
Light Source	Working Voltage	AC220V
	Lamp Head Power	2*150W
	Luminous Flux	2*3600lm
	Vertical Rotation	0~135
	Bulb Average Service Life	100000H
	Rated Output Power	0.7kW optional
	Generator type	Inverter Generator
	Continuous Working Time	6H
	Max. Power	0.7KW
	Start Method	hand start
	Cooling Method	forced air cooling
	Oil capacity	0.25L
	Noise (at 7m)	70db
Leakage protection function	have	
Fuel tank rated capacity	2.1L gasoline	
Telescopic cylinder	Minimum height	1500mm
	Max. Raised Height	5200mm
	Lifting platform Lifting power	generator, electric linear actuator
	Material	aviation-grade aluminum
	Control method	Panel
Dimensions	Length (fully retracted) 800±50mm Width (fully retracted) 600±50mm Height	
Wind Resistance Rating	Level 6	
Weight	Kg	50kg±2.5kg

► **Introduction**

Provides mobile lighting for high-brightness large-area night lighting and other work sites during on-site operations, accident emergency repairs, abnormal situation handling in various flammable and explosive places for units such as military, railways, electric power, public security, petrochemicals.

Dual vehicle model adaptation: Tool-free three-part split for transport.

Dual 150W high-efficiency LEDs: long life, large coverage.

Mast red/blue warning light: multi-mode 4H2 flashing.

Electric push rod lifting: dual height + wide angle lighting.

YJB6-LED35- Explosion-Proof Floodlight Work Light ➡

External Dimensions: 220*246*646mm

Rated Voltage: 24V

Rated Capacity: 20Ah

Working Voltage: 24V

Luminous Flux: 3000lm

Weight: 18kg



■ **Technical Parameters**

No.	ParameterName	Unit	Value	
1	RatedVoltage	V	24	
2	RatedCapacity	Ah	20	
3	LightSourceLED	W	30	
4	RatedCapacity	Ah	20	
5	6100LightSourceHID	W	35	
6	WorkingVoltage	V	24	
7	WorkingCurrent	A	1	
8	LuminousFlux	lm	3000lm	
9	AverageServiceLife	h	>10000	
10	Continuous Discharge Time	StrongLight	h	12
		WorkingLight	h	20
11	ChargingTimeNormalUse	h	8	
12	WhenBatteryDepleted	h	>10	
13	BatteryServiceLife	cycles	1000	
14	Dimensions	mm	220*246*646	
15	Weight	Kg	18	

► Introduction

Provides mobile lighting for high-brightness large-area night lighting and other work sites during on-site operations, accident emergency repairs, abnormal situation handling in various flammable and explosive places for units such as military, railways, electric power, public security, petrochemicals.

Top-level explosion-proof certification, building a solid safety line: GB3836.2-200 reaches the highest explosion-proof level.

Efficient and reliable lighting, ensuring operation endurance: Easily covers large operation areas, reducing shadows and visual blind spots.

YJB7-LED35- Explosion-Proof Floodlight Work Light ➤

External Dimensions: 220*246*646mm

Light Source: HID Xenon

Capacity: 12Ah

Discharge Time: >8H

Power: 35W

Voltage: 24V

Lighting Mode: Floodlight

Charging: Direct Charging

Weight: 15kg



► 产品介绍/Introduction

Suitable for use as signal indication, safety warning, and working lighting in public security, military, firefighting, railway, electric power, oil fields, petrochemicals, petroleum, metallurgy, gas maintenance, industrial and mining enterprises, various field worksites, and flammable and explosive places.

Intelligent endurance, economical, environmentally friendly and durable: High-energy maintenance-free battery, large capacity, long life, low self-discharge rate.

YJB12-LED27- Portable Mobile Lighting System ➤

External Dimensions: 330*450*170mm

Rated Voltage: 14.8V

Rated Capacity: 10Ah

LED Light Source: 27W

Current: 300mA

Average Service Life: 10000h

Continuous Discharge Time: >15h

Charging Time: When battery depleted ≤8h

Battery Service Life: approx. 1000 (cycles)

Weight: 8.5kg

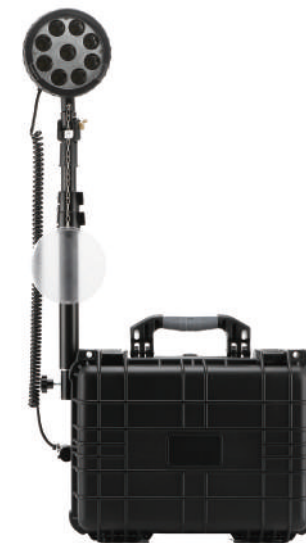

► **Introduction**

Product Introduction/Introduction Provides mobile lighting for high-brightness large-area night lighting and other work sites during various on-site operations, accident emergency repairs, abnormal situation handling in units such as military, railways, electric power, public security, petrochemicals.

friendly and durable: High-energy maintenance-free battery, large capacity, long life, low self-discharge rate.

Flexible adjustment, adaptable to various scenarios: Three-section telescopic pole combined with multi-angle adjustment of the lamp head, no dead angle lighting.

YJB5-LED27- Lightweight Mobile Lighting System ➤

Dimensions: 435*210*240mm

Rated Voltage: DC14.8V

Rated Capacity: 10Ah

Rated Power: 27W

Light Source: LED

Average Service Life: >10000h

Weight: 7kg

Enclosure Protection Grade: IP66

Charging Time: 8h (normal use) / 12h (battery depleted)

Continuous Discharge Time: 10h (strong light) / 18h (working light)



► **Introduction**

Applied to work sites requiring large-area high-brightness lighting such as field training, construction operations, emergency repair, flood control, medical rescue, film and television shooting, accident handling. Electric power, railway, military, police, firefighting, industry, exploration, construction, safety rescue, etc.

YJB11-LED27-Portable Mobile Lighting System ➤

Dimensions: 285*245*170mm

Rated Voltage: 12V;

Rated Capacity: 10Ah

LED Light Source: 27W;

Current: Strong Light 0.7A, Working Light 0.35A

Luminous Flux: Strong Light 2000lm, Working Light 1000lm

Average Service Life: 100000 hours

Continuous Discharge Time: Strong Light 6h;

Working Light 13h; Low Light 24h

Charging Time: <8h

Battery Service Life: approx. 1000 (cycles);

Weight: 4.6kg



► **structural characteristics**

High brightness, lamp luminous flux >4000 lm, illumination distance up to 1000 meters. Lightweight, total net weight of lamp 1.58Kg, can be handheld or shoulder-carried, more convenient to carry, feels lighter underwater due to buoyancy.

Long time, strong light discharge time >3h, working light discharge time >5h, meeting the needs of long-term night construction lighting. High explosion-proof, can be safely used in various flammable and explosive places.

High protection, the lamp uses an imported piezoelectric switch from Israel, overall protection level IP68, resistant to 1m drop, can be reliably used in various rain and snow environments.

YJB14-LED35-70- Diving Light ➤

External Dimensions: 225*85mm

Battery Rated Voltage: DC12

Battery Rated Capacity: 6600mAh

Rated Power: 35~70W

Weight: 1.58kg

Operating Environment: -20~40°C

Protection Rating: IP68



■ **Technical Parameters**

No.	Parameter Name	Unit	Value	
1	Rated Voltage	V	DC12	
2	Rated Capacity	Ah	6600mah	
3	Rated Power	W	35~70	
4	Light Source	Average Life	h	50000
		Color Temperature	k	5000~6000
5	Lighting Angle	Horizontal Direction	Angle	9~30
6	Lighting Type	/	spotlight / floodlight	
7	Strong Light Continuous Lighting Time	h	≥3	
8	Continuous Lighting Time	h	≥5	
9	Charger Input Voltage	V	AC100-230	
10	Diving Depth	metres	100	
11	Battery Service Life	Cycle	≥500	
12	Charging Time	h	<6	
13	Dimensions: Length * Diameter	mm	225x85	
14	Weight	KG	1.58	
15	Operating Environment	°C	-20~40	
16	Protection Rating	/	IP68	

Portable Courtyard Lamps

► Introduction

The mobile moon light is a high-power, mobile, high-intensity lighting device, widely used in high-risk or outdoor operation scenarios such as petroleum, chemical, electric power, firefighting, railway, and engineering construction, especially suitable for environments requiring large-area, high-brightness temporary lighting. This type of lamp usually has functions such as explosion-proof, waterproof, wind-resistant, remote control, and automatic lifting, and can provide stable and reliable lighting support under complex conditions such as night rescue, accident handling, and field construction.

TYB4-JLZ1000-Mobile Moon Light

Rated Voltage: AC220V

IP Grade: IP65

External Packaging Dimensions (separate type)

Lamp Pole: 150*110*1550mm

Lamp: 320*320*710mm

Body: 830*500*750mm

Weight: approx. 85kg



■ Technical Parameters

Rated Voltage	AC220V	
IP Rating	IP65(灯具)	
Working Time	When Filled with Fuel Once / Single Fueling	13h
	Mains Power	Long Time
Light source power	Metal Halide Lamp	1000w
	Luminous Flux	14000lm
Illumination Direction	Lamp Head	Omnidirectional
	Illumination Range	120-meter diameter
Lamp Pole Control	Lifting Height	4.5 meters / three-node
	Lifting Method	Pneumatic Lifting
	Lifting Equipment	Small Air Compressor
Generator	Output Voltage	A220V
	Rated Power	3kw
	Start Method	Manual Start
	Fuel Type	Gasoline
Sphere	Fuel Tank Capacity	15L
	Sphere Diameter	1000mm
	Inflation Method	Inflatable
Chassis	Inflation Time	≤30s
	Caster Configuration	2 Swivel Casters / 2 Fixed Casters
	Caster Size	5 Inches
	Brake Method	Foot brakes system
External Packaging Dimensions (Separate Type)	Wind Resistance Level	≤ Level 8
	Lamp Pole (Carton)	150*110*1550mm
	Lamp (Carton)	320*320*710mm
	Body	830*500*750mm
Weight	Overall	Approximately 85 kilograms

► Introduction

This mobile emergency lighting device is specifically designed for large-area, high-brightness outdoor illumination and is widely used in complex environments such as nighttime construction, disaster relief, fire rescue, and traffic control. It features 360° panoramic lighting, automatic lifting mast, wireless remote control, and rain and wind resistance, enabling stable operation in harsh weather conditions. It is one of the core pieces of equipment for ensuring operational safety.

TYB5-Omnidirectional Floodlight Work Light ➔

Rated Voltage: AC220V/50Hz

IP Rating: IP65

External Dimensions: 1650*510*780mm

Wind Resistance Level: Level 6

Max. Inclination: ≤15°

Weight: 85kg



■ Technical Parameters

Rated Voltage	AC220V/50Hz	
IP Rating	IP Rating: IP65	
light source	Working Voltage	AC220V
	Lamp Head Power	4*500w
	Luminous Flux	4*9500lm
	Bulb Average Service Life	3000
Generator Set	Rated Output Voltage	AC220V
	Rated Output Power	3KW
	Continuous Working Time	13h
	Start Method	hand movement
	Noise Level	≤89db(7m)
	Fuel tank rated capacity	15L gasoline
Telescopic cylinder	Minimum height	1600mm
	Max. Raised Height	4500mm
	Lifting and Lowering time	30s(aerodynamic)
	Material	Aviation-grade aluminum
	Lifting and Lowering time	aerodynamic
External Dimensions	1650*510*780mm	
Wind Resistance Level	Level 6	
Maximum Inclination	≤15°	
Weight	KG	85

Civilian portable mobile lamps

► **Function**

Floodlight knob switch:

Rotate to turn on and off the middle floodlight, rotate to control the brightness.

Spotlight switch:

Click to turn on and off the spotlight.

With solar energy and Type-c charging function at the same time.

The whole circuit and battery have overcharge, over discharge and reverse connection protection.

B42-Camping Lantern ➡

Net weight: 244g

Lamp beads: COB+3030

Battery: Removable 1800 mAh 18650 polymer battery

Running time: 3-72H

Charging time: 4-5H

Brightness: 5-90 lumens

IP Rating: IPX3

Color: black, green, beige



► **Function**

Click the switch to turn on the light and change gears :

white light on--yellow light on--white and yellow light on at the same time--white and yellow light flash together--off.

Spotlight switch:

Click the brightness switch to change the brightness.

B12H-Camping Lantern ➡

Net weight: 215g

Lamp beads: SMD 5730 white light + yellow light + red light

Battery: 4400mah 18650 battery

Running time: 6-50H

Brightness: 100-800 lumens

IP Rating: IPX4

Color: black

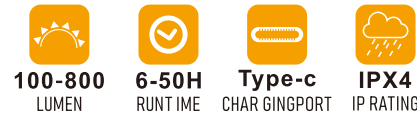

► **Function)**

Click to turn on:

middle white light high brightness -- middle white light low brightness -- side light 2835 white light high brightness -- side light 2835 white light low brightness -- side light 2835 yellow light high brightness -- side light 2835 yellow light low brightness -- side light 2835 red light bright -- side light 2835 red light flashing -- turn off.

B28-Camping light ➔



Net weight: 63g
 Lamp beads: domestic XPG2+2835 white, yellow and red light
 Battery: 3pcs AAA batteries/dedicated 1100 mAh battery pack
 Running time: 3-150H
 Brightness: 5-220 lumens
 IP Rating: IPX3
 Color: black



► **Function**

Function keys:

click highlight–steady light–low light–strobe–SOS–off.
 Press and hold the switch and the side light will turn white – click and turn yellow – turn off.

B65-32-Camping Lantern with the Remote ➔

Product name: Remote control Camping light
 Material: ABS
 lamp beads: white light
 Maximum luminous value: 300LM(100%)
 Working voltage: 3.7V/5W
 Discharge current: 1.26A
 Running time: 4 H (100%)
 Battery: 2*18650-1200mah polymer
 Charging time: 2.5 h Charging method: MICRO interface data cable

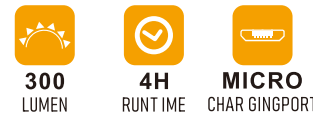

► **Function**

Function keys:

click highlight–steady light–low light–strobe–SOS–off.
Press and hold the switch and the side light will turn white – click and turn yellow – turn off

B65-31-Camping Lantern with the Remote ➤

Product name: Electronic display screen Camping light
Material:ABS
lamp beads:white light
Maximum luminous value: 300LM(100%)
Working voltage:3.7V/5W
Discharge current:1.26A
usage time:2 H (100%)
Battery: 1*18650-1200mah polymer Charging time: 2.5 h
Charging method: MICRO interface data cable



 **300**
LUMEN
 **2H**
RUNT IME
 **MICRO**
CHAR GINGPORT

► **Function**



Function keys:

Highlight–steady light–Low light–flash–SOS–Off;

B65-Camping Lantern with the Remote ➤

Product name: Electronic display screen Camping light
Material:ABS
lamp beads:white light
Maximum luminous value:300LM(100%)
Working voltage:3.7V/5W
Discharge current:1.26A
Running time:3 H (100%)
Battery: 2*18650-1200mah polymer Charging time: 2.5 h
Charging method: MICRO interface data cable



 **300**
LUMEN
 **3H**
RUNT IME
 **MICRO**
CHAR GINGPORT

► **Function**

Single click normal switch:

white light high brightness -- white light low brightness -- red light bright -- red light flashing -- off.

Single click induction switch:

white light high brightness -- white light low brightness -- red light bright -- red light flashing -- off.

In any gear position in induction mode, wave your hand in front to control the light switch.

B10-Headlamp ➔



Net weight: 35g

Lamp beads: domestic XPE

Battery: 650mah polymer battery



Running time: 4-12H

Brightness: 20-100 lumens

IP rating : IPX3

Charging interface: Type-c

Color: stock black and red, white and orange. Customizable

			
20-100 LUMEN	4-12H RUNT IME	Type-c CHAR GINGPORT	IPX3 IP RATING

► **Function**

B55-Kids Headlamp ➔

Net weight: 65g

Lamp beads: domestic XPE+2714 SMD lamp beads

Battery: 800mah polymer battery





Running time: 6-24H

Brightness: 10-120 lumens

IP rating : IPX3

Color: white and black, black and gold



			
10-120 LUMEN	6-24H RUNT IME	Type-c CHAR GINGPORT	IPX3 IP RATING

► **Function**





Click the switch to turn on the light and shift gears:

weak white light for eyes -- weak white light -- high white light -- off;

B56-Kids Headlamp ➤

Net weight: 64g
 Lamp beads: 2*domestic XPE
 Battery: 800mah polymer battery
 Running time: 6-24H
 Brightness: 10-120 lumens
 IP rating : IPX3
 Color: white and black, black and gold



			
10-120 LUMEN	6-24H RUNT IME	Type-c CHAR GINGPORT	IPX3 IP RATING

► **Function**

Single click on the normal switch:

medium white light -- high white light -- low white light -- off.



Single click on the induction switch:

turn on the induction mode, click again to exit. In the induction mode, waving your hand to the side controls the current gear on and off.

B7S-Headlamp ➤

Net weight: 38g
 Lamp beads: 2*XPE
 Battery: 500mah polymer battery
 Running time: 3-12H
 Brightness: 15-90 lumens
 IP rating : IPX3
 Charging interface: Type-c
 Color: black



			
15-90 LUMEN	3-12H RUNT IME	Type-c CHAR GINGPORT	IPX3 IP RATING

► **Function**

Single click on the normal switch:

white light high brightness -- white light medium brightness -- white light low brightness -- white light flashing -- red light bright -- red light flashing -- off.

Single click on the induction switch:

turn on the induction mode, click again to exit. In the induction mode, waving your hand to the side controls the current gear on and off.

Press and hold the normal switch for 2S for each gear above to turn it off, click again to turn it on and return to the current gear.

B87-Headlamp ➤

- Net weight: 74g
- Lamp beads: domestic XTE + red light
- Battery: 1800mah polymer battery
- Running time: 3-15H
- Brightness: 20-350 lumens
- IP rating: IPX3
- Charging interface: Type-c
- Color: black



20-350 LUMEN	3-15H RUNT IME	Type-c CHAR GINGPORT	IPX3 IP RATING

► **Function**

Single click normal switch:

strong light -- medium light -- weak light -- red light on -- red light flashing -- off.

Single click induction switch:

enter induction mode, then click to exit. In induction mode, waving your hand in front controls the current gear on and off.

B74-Headlamp ➤

- Net weight: 91g
- Lamp beads: domestic XPG3
- Battery: 1800mah polymer battery
- Running time: 6-48H
- Brightness: 20-550 lumens
- IP rating: IPX3
- Charging interface: Type-c
- Color: black, desert yellow



20-550 LUMEN	6-48H RUNT IME	Type-c CHAR GINGPORT	IPX3 IP RATING

► **Function**

Single-click the spotlight switch:

low white light -- high white light -- off.

Single-click the floodlight switch:

low white light -- high white light -- red light -- red light flashing -- off.

Single-click the floodlight switch:

turn on the sensing mode, click again to exit. In the sensing mode, waving your hand to the side controls the current gear on and off.

Double-click the switch:

spotlight and floodlight light up together
Each gear has a memory function. After working for more than 5 seconds, it will be the original gear when it is turned on again.

B51-Headlamp ➔

Net weight: 61g/86g

Lamp beads: domestic XPG white and yellow light

Battery: 3pcs AAA batteries/dedicated 1100 mAh battery pack

Running time: 3-150H

Brightness: 5-300 lumens

IP rating: IPX3

Color: black, green



 **5-300**
LUMEN
 **3-150H**
RUNT IME
 **Type-c**
CHAR GINGPORT
 **IPX3**
IP RATING

► **Function**

Click the regular switch:

light bar high--light bar low--side light high--side light low--off.

Click the induction switch:

light bar high--light bar low--side light high--side light low--off.
In any gear position in the induction mode, wave your hand at the side to control the light switch.
When the light is on, the rear red warning light is on at the same time.

B47-Headlamp ➔

Net weight: 85g

Lamp beads: domestic XPG + 3W COB light bar

Battery: 1200mah polymer battery

Running time: 2-9H

Brightness: 50-450 lumens





IP rating: IPX3

Charging interface: Type-c

Have oily feel

Color: Stock black. Customizable



 **50-450**
LUMEN
 **2-9H**
RUNT IME
 **Type-c**
CHAR GINGPORT
 **IPX3**
IP RATING

► **Function**

Click the regular switch:

light bar high--light bar low--side light high--side light low--off.

Click the induction switch:

light bar high--light bar low--side light high--side light low--off;

In any gear position in the induction mode, wave your hand at the side to control the light switch.

When the light is on, the rear red warning light is on at the same time.

B72-Headlamp ➤

Net weight: 100g

Lamp beads: domestic XXTE+ COB light strip

Battery: 1800mah polymer battery

Running time: 4-24H

Brightness: 10-550 lumens

IP rating: IPX3

Charging interface: Type-c

Have oily feel

Color: Stock black. Customizable



			
30-190 LUMEN	4-15H RUNT IME	Type-c CHAR GINGPORT	IPX3 IP RATING

► **Function**

Single click on the normal switch:

white light high--medium light--low light--red light--off.

Press and hold the normal switch for 2 seconds to turn it on, single click to shift gears: red light--red light flashing--off

Single click on the induction switch:

enter the induction mode, then click to exit. In the induction mode, waving your hand in front of you controls the current gear on and off.

B35-Headlamp ➤

Net weight: 75g

Lamp beads: domestic XPG

Battery: 1200mah polymer battery

Running time: 4-15H

Brightness: 30-190 lumens

IP rating: IPX3

Charging interface: Type-c or micro usb

Color: black and silver



			
30-190 LUMEN	4-15H RUNT IME	Type-c or Micro CHAR GINGPORT	IPX3 IP RATING

► **Function**

Left switch:

side light high brightness -- low brightness, red light high brightness -- flashing -- off.

Right switch:

strong light 100% -- medium light 50% -- weak light 25% -- SOS -- off.

B29-Headlamp ➤

Net weight: 35g

Lamp beads: 1*domestic XPG2, 2*5730 white light, 2*2835 red light

Battery: 3 AAA batteries

Running time: 10-60H (different dry batteries will vary)

Brightness: 5-180 lumens

IP rating: IPX3

Color: regular black, blue, orange



50-180
LUMEN



10-60H
RUNT IME



IPX3
IP RATING

LUMEN RUNT IME CHAR GINGPORT IP RATING

► **Function**

Single click conventional switch:

main light high--main light low--red light on--red light flashing--off.

Single click induction switch:

main light high--main light low--red light on--red light flashing--off;
When in induction mode, wave your hand in front to control the light switch.

B3-Headlamp ➤

Net weight: 45g

Lamp beads: domestic XPE

Battery: 800mah polymer

Running time: 4-16H

Brightness: 50-120 lumens

IP rating: IPX3

Charging interface: Type-c or micro usb

Color: stock black, white, orange. Customizable



50-120
LUMEN



4-16H
RUNT IME



Type-c or Micro
CHAR GINGPORT



IPX3
IP RATING

► **Function**





Click the switch to turn on the light and change gears:

High light -- Medium light -- Low light -- Red light -- Red light SOS -- Off.

B2S-Headlamp ➤



Net weight: 51g
 Lamp beads: domestic XPE
 Battery: 1200mah polymer
 Running time: 4-16H
 Brightness: 10-180 lumens
 IP rating : IPX4
 Color: black and white

			
50-180 LUMEN	10-60H RUNT IME	Type-c CHAR GINGPORT	IPX3 IP RATING

► **Function**

Gear position:

White light 100% bright – White light 30% bright – Red light 100% bright – Red light flashing, 100% induction – 100% red light induction.

B65-Headlamp ➤

Product name: LED sensor headlight Material: ABS

lamp beads: COB red and white light

color temperature: 7000K

Maximum luminous value: 350LM(100%)

Working voltage: 3.7V

Discharge current: 1.26A

Running time: 4 H (100%) 8 H (30%) 30H (10%)

Irradiation distance: 10M

Battery: 103040-1200mah polymer Charging time: 2.5h





size: 63x44.6x35.6mm

Weight: 70g

Dustproof and waterproof index: IP33



Charging method: Type-C interface

			
350 LUMEN	4-30H RUNT IME	Type-c CHAR GINGPORT	IP33 IP RATING

► **Function**

Gear position:

K1: XPG100% bright – COB100% bright – (XPG+COB) 100% bright – red light – red light flashing;
 K2: XPG induction – COB induction – (XPG+COB) induction.

B62-Headlamp ➤

Product name: LED sensor headlight

Material: ABS

lamp beads: XPG2+COB red and white light

color temperature: 7000K

Maximum luminous value: 500LM(XPG+COB100%)

Working voltage: 3.7V

Running time: 2.5-4H

Irradiation distance: 120M

Battery: 103040-1200MAH polymer Charging time: 3.5H

Charging method: Type-C interface

size: 63.1*44.3*38.6mm

weight: 64.5g

Dustproof and waterproof index: IP33



120
LUMEN



2.5-4H
RUNT IME



Type-c
CHAR GINGPORT



IP33
IP RATING

► **Function**

Gear position:

K1: XPG100% – COB100% – (XPG+COB)100%– OFF;
 K2: XPG induction–COB induction–(xpg+cob) induction K1 long press stepless dimming

B801-Headlamp ➤

Product name: LED sensor headlight

Material: ABS

lamp beads: xpg-2+COB

color temperature: 7000K

Maximum luminous value: 500LM(100%)

Working voltage: 3.7V

Discharge current: 2.35A

Running time: 2.5-5H

Irradiation distance: 10M-50M

Battery: 103450-1800mahpolymer Charging time: 3H

Charging method: Type-C

Size: 78*50.5*48.2mm weight: 96g

Dustproof and waterproof index: IP44 Real-time power display function: yes



10-50
LUMEN



2.5-5H
RUNT IME



Type-c
CHAR GINGPORT



IP44
IP RATING

► **Function**

Ear position:

LED100%-COB100%- (LED+COB) 100%

B78-Headlamp ➤

Product name: LED sensor headlight

Material: ABS+TPR

lamp beads: COB+5WLED

color temperature: 6500 K

Maximum luminous value: 500 lumen (XPG+XPE)

Working voltage: 3.7 V

Discharge current: 1.7A

Running time: 2.5-6.5 H

Irradiation distance: High 50M-Middle 25M-Low 10M

Battery: 902554-1500mah

Charging time: 3h

Charging method: Type-C

size: 98.5*61.2*49.5mm

weight: 140g

Dustproof and waterproof index: IP44

Real-time power display function: yes



500
LUMEN



2.5-6.5H
RUNT IME



Type-c
CHAR GINGPORT



IP44
IP RATING

► **Function**

2 hours of battery life on a single battery, removable battery.

B103-Headlamp ➤

Product name: Huawei backpack headlight

material: aluminum alloy

lamp beads: P50/white laser

Maximum luminous value: 350LM(100%)

Working voltage: 3.7V/5W

Discharge current: 1.26A

Running time: 2 H (100%)

Irradiation distance: zoom stretch

Battery: 2*18650-1200*2mah polymer Charging time: 2.5 h Charging method: TYPE-C



350
LUMEN



2H
RUNT IME



Type-c
CHAR GINGPORT

► **Function**

2 hours of battery life on a single battery, removable battery.

B103-2-Headlamp ➤

Product name: Output electronic display sensor headlight

material: aluminum alloy

lamp beads: P50/white laser

Maximum luminous value: 350LM(100%)

Working voltage: 3.7V/5W

Discharge current: 1.26A

Running time: 2 H (100%)

Irradiation distance: zoom stretch

Battery: 2*18650-1200*2mah polymer Charging time: 2.5 h Charging method: TYPE-C



350
LUMEN



2H
RUNT IME



Type-c
CHAR GINGPORT

► **Function**

2.5 hours of battery life on a single battery, removable battery

B8-1-Headlamp ➤

Product name: Headlight

material: aluminum alloy

lamp beads: 30W white laser

Maximum luminous value: 800LM(100%)

Working voltage: 3.7V/30W

Running time: 2.5 H (100%)

Irradiation distance: zoom stretch Battery: 3*18650-2400*3mah polymer

Charging time: 2.5 hours Charging method: TYPE-C



800
LUMEN



2.5H
RUNT IME



Type-c
CHAR GINGPORT

► **Function**

2 hours of battery life, removable battery.

B138-Headlamp ➤

Product name: Output electronic display sensor headlight (with digital display)

material: aluminum alloy

lamp beads: white laser

Maximum luminous value: 310LM(100%)

Working voltage: 3.7V/10W

Running time: 2 H (100%)

Irradiation distance: zoom stretch

Battery: 2*18650-1200*2mah polymer

Charging time: 2.5 hours Charging method: TYPE-C



310
LUMEN



2H
RUNT IME



Type-c
CHAR GINGPORT

► **Function**

2.5 hours of battery life on a single battery, removable battery

B135-Headlamp ➤

Product name: B135 Huawei backpack headlight

material: aluminum alloy

lamp beads: white laser

Maximum luminous value: 310LM(100%)

Working voltage: 3.7V/10W

Running time: 2 H (100%)

Irradiation distance: zoom stretch

Battery: 2*18650-1200*2mah polymer

Charging time: 2 hours Charging method: TYPE-C



310
LUMEN



2H
RUNT IME



Type-c
CHAR GINGPORT

► **Function**

Function key:

single click highlight – low brightness – flash.

B116-Headlamp ➤

name: B116 headlight

Material: aluminum alloy

Bulb type: white laser

Maximum lumen : 1000LM (100%)

Working voltage: 3.7V/10W

Running time: 2 H (100%)

Battery: 2*18650-1200*2mah polymer

Charging time: 2. hours

Charging method: USB charging cable

Product size: 5.5*4CM

Weight: 262g



 **1000**
LUMEN
  **2H**
RUNT IME
  **Type-c**
CHAR GINGPORT

► **Function**

Function key:

single click highlight – low brightness – flash.

B113-Headlamp ➤

Name: B113 headlight

Material: aluminum alloy

lamp beads: white laser

Maximum lumen value: 1000LM (100%)

Working voltage: 3.7V/10W

Running time: 2 H (100%)

Battery: 2*18650-1200*2mah polymer



Charging time: 2. hours

Charging method: TYPE-C

Product size: 5.6*4cm

Weight: 370g



 **1000**
LUMEN
  **2H**
RUNT IME
  **Type-c**
CHAR GINGPORT

► **Function**

Battery used:

3*AAA

Product size:

6*3.5*4.4cm (color box)

Packing (middle box) size:

26.6 × 15.5 × 9.5cm (10PCS, 2kg)/outer box 28.6*33*21cm

BX100R-Headlamp ➡

Product lamp beads: CREE+COB(6500K)+

Brightness lumens: 550-1000-25/480-90 lumens

Light source color temperature: white light + red light

Product material: ABS/PC plastic

IP rating: IPX8

Running time: 20-76-4-11-115-66h

Shell color: orange

Switch gear: Main light-5th gear/auxiliary light-2nd gear (SOS)

Light effect range: 118-170-85 meters/30-13 meters

Light effect mode: spotlight/flood light

Carton quantity:

40 sets/carton

Carton weight:

net weight 8kg/gross weight 9kg



550-1000 LUMEN	3-72H RUNT IME	Type-c CHAR GINGPORT	IPX8 IP RATING

► **Function**

Gear position:

COB30% – COB100% – front light 100% – Off.

B505-Work Light ➡

Product name: LED work light

Material: ABS+PC

lamp beads: COB+XPE

color temperature: White light6500K XPE 7000K

Maximum luminous value: 350LM (COB100%)

Working voltag: 3.7V

Discharge current: 0.78A

Running time: 6.5H (30%) 4 H (100%) 7H (100%)

Irradiation distance: 10 M (30%) 10M (100%) 10M (100%)

Battery: 103040-1200mah

Charging time: 2.5hours

Charging method: Type-C

size: 31x42x154mm

weight: 108g

Dustproof and waterproof index: IP33

Real-time power display function: yes

350 LUMEN	4-7H RUNT IME	Type-c CHAR GINGPORT	IP33 IP RATING



BATTERY INDICATOR



MAGNET

► **Function**

Gear position:

COB30% – COB100% – front light – Off.

B606- work light ➤

Product name: LED work light

Material: ABS+PC

lamp beads: COB+3030

color temperature: 7000K

Maximum luminous value: 450LM (COB100%)

Working voltag: 3.7V

Discharge current: 0.3A

Running time: 5.5H-20H

Irradiation distance: 10 M (30%) 10M (100%) 10M (100%)

Battery: 18650-2000mah

Charging time: 3H

Charging method: Type-C

size: 33x46x165mm

weight: 108g

Dustproof and waterproof index: IP33

Real-time power display function: yes



450
LUMEN



5.5-20H
RUNT IME



Type-c
CHAR GINGPORT



IP33
IP RATING



BATTERY
INDICATOR

MAGNET

► **Function**

Gear position:

COB Warm Light – COB White Light – (Warm Light + White Light) front light 100% – Off

B608-work light ➤

Product name: Two-color work light

Material: ABS+PC

lamp beads: COB+XPE

Color temperature: white light 6500K yellow light 2700K XPE 7000K

Maximum luminous value: 500LM (warm light + white light)

Working voltag: 3.7V Discharge current: 1.65A

Running time: 4H (COB warm light)

4 H (COB white light) 2H (warm light + white light) 8H (front light 100%)

Irradiation distance: 10 M (COB warm light))

10M (COB white light) 10M ((warm light + white light) 20M (front light 100%)

Battery: 18650-2000mah

Charging time: 3.5h

Charging method: TYPE-C

size: 37x46x165mm

weight: 139g

Dustproof and waterproof index: IP33

Real-time power display function: yes



500
LUMEN



4H
RUNT IME



Type-c
CHAR GINGPORT



IP33
IP RATING



BATTERY
INDICATOR

MAGNET

► **Function**

Charging voltage: 5V
Battery capacity: 1 18650 2000mah
Carton size: 41 × 27 × 43cm
Charging time: 6-8h
Size: 2.5 × 3.5 × 38cm
Product weight: 180g Set weight 207g
Battery used: 18650 lithium battery
Battery used: 4.5 × 4 × 39cm (color box)

B303- work light ➤

lamp beads: COB
 Brightness lumens: 500 lumens
 Light source color temperature: warm white light
 material: ABS plastic
 Protection level: IPX4
 Running time: 4-6h
 Wattage power: 8W
 Casing color: black
 Switch position: Rotate to adjust brightness
 Light effect range: within 50 meters
 Light effect mode: floodlight type

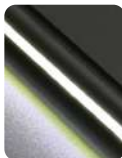

STEPLESS

 500 LUMEN	 4-6H RUNT IME	 MICRO CHAR GINGPORT	 IPX4 IP RATING
--	---	---	--





► **Function**

Charging voltage: 5V
Battery capacity: 1 103040 1200mah
Carton size: 43X36X26cm
Charging time: 3-4h
Size: 3.1 × 4.2 × 15.4cm
Product weight: net weight 108g/gross weight 136g
Battery: polymer lithium battery
Box size: 4.7 × 3.8 × 16cm
Carton quantity: 50 pieces/small box, 100 pieces/large box
Charging method: TPC direct charging
Carton weight: 7.3kg/14kg

B505A-work light ➤

lamp beads: COB+XPE
 Brightness lumens: 350 lumens
 Light source color temperature: white light 6500K
 material: ABS plastic + PET silicone
 Protection level: IPX4
 Running time: 3-7h
 Wattage power: 5W
 Casing color: black and red
 Switch position: low brightness/high brightness & ceiling light
 Lighting range: within 20 meters
 Lighting mode: floodlight type



 350 LUMEN	 3-7H RUNT IME	 Type-c CHAR GINGPORT	 IPX4 IP RATING
--	--	---	---

► **Function**

Charging voltage: 5V
Battery capacity: 1 18650 2000mah
Charging time: 4-5h
Battery used: 18650 lithium battery
Battery capacity: 1 18650 2000mah
Size: 16.5 x 3.7 x 4.6cm
Box size: 17 x 4.7 x 4.3cm
Carton size: 25.5 x 23 x 25cm
weight: Net weight 139g Gross weight 175g
Carton quantity: 50 sets/box

Carton weight: 9.5kg
Charging method: TPC direct charging

B606A- work light ➤

lamp beads: dual-color-COB+XPE
 Brightness lumens: 380-500 lumens
 Light source color temperature: yellow light/white light/dual light
 material: ABS plastic
 Protection level: IPX4
 Running time: 2/4-8h
 Wattage power: 10W
 Casing color: black and red
 Switch position: yellow light-white light-dual light-ceiling light
 Light effect range: 10-20 meters
 Light effect mode: flood light type



500 LUMEN	4-6H RUNT IME	Type-c CHAR GINGPORT	IPX4 IP RATING

► **Function**

Charging voltage: 5V
Charging time: 6-7h
Battery: polymer lithium battery
Battery capacity: 1 set of 5000mah
Size: 7.5 x 4.3 x 30 c m (color box)
Box size: 4.7 x 3.8 x 16cm
Carton size: 58 x 38 x 31cm
Product weight: 352g / gross weight 396g
Carton quantity: 50 pieces/box
Carton weight: 20kg / gross weight 21kg
Charging method: TPC-fast charging

B707- work light ➤

lamp beads: XPG/COB
 Brightness lumens: 800 lumens
 Light source color temperature: white light/red light
 material: ABS plastic
 Protection level: IPX5
 Running time: 7-24h
 Wattage power: 10W
 Casing color: black and red
 Switch position: side light-medium bright/
 high bright & top light bright long press red light
 Light effect range: 10-50 meters
 Light effect mode: integrated focusing and flooding

800 LUMEN	7-24H RUNT IME	Type-c CHAR GINGPORT	IPX5 IP RATING



BATTERY INDICATOR



SUPPORT ROTATING

► **Function**

Charging voltage: 5V	Battery used: 18650 lithium battery pack	Box size: 52 × 5.3 × 5.3cm	Carton quantity: 25pcs
Charging time: 5-6h	Battery capacity: 4400mah	Packing size: 54 × 28 × 28.5cm	Carton weight: net weight 12.6kg/gross weight 13.6kg
Charging method: Type-c direct charging	Size: 51 × 4.7 × 4.7cm	Product weight: net weight 424g/gross weight 508g	

B808-work light ➡

lamp beads: two-color COB lamp beads
 Brightness lumen: 1250lm/900lm/740lm
 Light source color temperature: warm white light 4500/
 white light 6500/yellow light 2700
 material: ABS plastic
 Protection level: IP55
 Running time: 3-12h
 Wattage power: 20W
 Casing color: black red/black and yellow
 Switch position: white light/yellow light/warm white light
 Light effect range: 5-10 meters
 Light effect mode: floodlight type



			
740-1250 LUMEN	3-12H RUN TIME	Type-c CHAR GINGPORT	IP55 IP RATING





► **Function**

Charging voltage: 5V	Batteries used: 2*18650 lithium batteries	Carton size: 34.5 × 31 × 20.6cm
Charging time: 3h	Size: 7.5 × 4.3 × 30cm (color box)	Product net weight: Net weight 252g Gross weight 282g
Charging method: USB-direct charging	Battery capacity: 4500mah	Carton quantity: 20 sets/carton
Product size: 6.6*3.3*16.7cm (folded size) 4.8*3*19.2cm (extended size) (color box)		Carton weight: net weight 5.04kg/gross weight 6.04kg

B1000-work light ➡

Product lamp beads: COB (6500K)
 Brightness lumens: 550-1000-25/480-90 lumens
 Light source color temperature: white light
 Product material: ABS/PC plastic
 IP rating: IP65
 Running time: 28-11-7.5h /16-6.5-31h
 Wattage power: 10W
 Shell color: black blue
 Switch gear: Main light-3 gears/floodlight-2 gears
 Light effect range: 118-170-85 meters/30-13 meters
 Light effect mode: spotlight/flood light



			
25-1000 LUMEN	7.5-28H RUN TIME	Type-c CHAR GINGPORT	IPX5 IP RATING

► **Function**

Charging voltage:

5V-3A/9V-2A

Charging time:

5.5-6h

Charging method:

USB-direct charging

Battery used:

2*18650 lithium batteries

Battery capacity:

4500mah

Size:

9.8*11.1*44.5cm
(color box)

Carton size:

36 x 26.5 x 34.5cm

Product net weight:

Net weight 450g Gross weight 480g

Carton quantity:

20 sets/carton

Carton weight:

net weight 9.6kg/gross weight 10.6kg

B1500- work light ➡

Product lamp beads: COB (2700-6500K)

Brightness lumens: 120-300-750-1500/14-14 lumens

Light source color temperature: white light + red light

Product material: ABS/PC plastic

IP rating: IPX5

Running time: 50-21-8-5.5h /195h

Wattage power: 10W

Shell color: black blue

Switch gear position: Main light-4 gears/auxiliary light-2 gears

Light effect range: 12-21-33-47 meters/

Light effect mode: spotlight/red light red flash



► **Function**

Charging voltage:

3.7-4.2

Charging time:

8-10h

Battery used:

18650 lithium battery

Battery capacity:

4 18650 battery packs 8000mah

Size:

length 20.5 x head 11.5 x tail 6.5cm

Box size:

21.5 x 12 x 15cm (color box)

Carton size:

47.5 x 32.5 x 67.5cm

Product net weight:

591g set weight 750g

Carton quantity:

20 sets/box

Carton weight:

16kg

Charging method:

DC direct charging

BZ400-searchlight ➡

lamp beads: Samsung-U2

Brightness lumens: 800 lumens

Light source color temperature: cold white light

material: aluminum alloy + ABS plastic

Protection level: IP55

Running time: 10-50h

Wattage power: 10W

Casing color: gold

Switch position: strong/weak/strobe/side light/

side red and blue flash

Light effect range: 500-1000 meters

Light effect mode: focusing long-range type

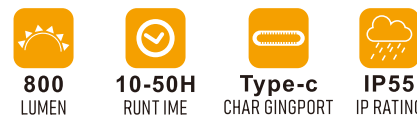

► **Function**

Charging voltage: USB-5V
Charging time: 4-6h
Battery used: 18650 lithium battery pack

Battery capacity: 2 18650 batteries 3000mah
Size: 8.5 × 7 × 17cm
Box size: 18 × 9.5 × 12cm (color box)

Product size: 48 × 30 × 55cm
Product net weight: 352g Set weight 459g
Carton quantity: 36 sets/box
Carton weight: Net 16.5kg/Gross 17.5kg

BZ500-searchlight ➤

lamp beads: T6*1/SMD*40/RED*20
 Brightness lumens: 600 lumens
 Light source color temperature: white light/red light
 material: ABS plastic/PET rubber coating
 Protection level: IP55
 Running time: 3.5-8h
 Wattage power: 10W
 Shell color: black and green
 Switch position: main light-high brightness
 /medium brightness Auxiliary light-high brightness
 /low brightness/red light/red flashing
 Light effect range: 50-200 meters
 Light effect mode: spotlight + floodlight



600 LUMEN	3.5-8H RUN TIME	USB CHARGING PORT	IP55 IP RATING

► **Function**

Charging voltage: 5V
Charging time: 6-8h
Battery used: 18650 lithium battery
Battery capacity: 6000mah

Size: 20 × 16 × 10.6cm
Box size: 21 × 16.4 × 11.2cm (color box)
Carton size: 47 × 41.5 × 51cm

Product net weight: net weight 350g gross weight 660g
Carton quantity: 24 sets/box
Carton weight: net weight 15kg/gross weight 16kg
Charging method: USB-direct charging

BZ600-searchlight ➤

lamp beads: SST20 lamp beads/SMD lamp beads
 Brightness lumens: 800 lumens
 Light source color temperature: white light/red light
 material: ABS plastic
 Protection level: IP55
 Battery life: 8-20h
 Wattage power: 10W
 Casing color: black
 Switch position: 8 positions
 Light effect range: 100-800 meters
 Light effect mode: spotlight/floodlight/red light warning



800 LUMEN	8-20H RUN TIME	Type-c CHARGING PORT	IP55 IP RATING

► **Function**

Charging voltage: 5V	Battery used: 18650 lithium battery
Charging time: 4-6h	Battery capacity: 3000mah
Charging method: USB-direct charging	Size: 17.5 × 10 × 7.5cm
Carton size: 48 × 30 × 55cm	Box size: 18 × 9.5 × 12cm (color box)

Net weight:
net weight 360g gross weight 452g

Carton quantity:
36 sets/box

Carton weight:
net weight 16.2kg/gross weight 17.2kg

BZ700-searchlight ➤

lamp beads: T6 lamp beads/SMD lamp beads
 Brightness lumens: 600 lumens
 Light source color temperature: white light/red light
 material: ABS plastic
 Protection level: IP44
 Running time: 3-12h
 Wattage power: 10W
 Casing color: black green/black orange
 Switch position: main light-3 gears/auxiliary light-4 gears
 Light effect range: 100-200 meters
 Light effect mode: spotlight/floodlight/red light warning



► **Function**

Charging voltage: 5v	Battery capacity: 8000mah
Charging time: 4.5h	Product size: 20 × 13.1 × 10.8cm (color box)
Charging method: USB-direct charging	Carton size: 57.6 × 48 × 23cm
Battery used: 4*18650 lithium battery	

Product net weight:
Net weight 635g Gross weight 875g

Carton quantity:
16 sets/carton

Carton weight:
Net weight 14kg/gross weight 15kg

BZ800-searchlight ➤

lamp beads: COB (6500K)
 Brightness lumens: 160-400-800 lumens/200-500-red-red flash
 Light source color temperature: white light/red light
 material: ABS/PC plastic
 IP rating: IPX6:IPX6
 Running time: 28-11-7.5h /16-6.5-31h
 Wattage power: 10W
 Shell color: black red
 Switch position: main light -3 gears/auxiliary light -4 gears
 Light effect range: 248-386-532 meters/19-28 meters
 Light effect mode: spotlight/flood/red light warning

